

Overview

The NMX-VCC-1000 Sereno Video Conferencing Camera (FG3211-10) is purpose-built for use with conferencing applications in huddle spaces and smaller meeting rooms. Sereno provides HD quality video, 120 degree field of view, and outstanding voice capture to deliver exceptional conference experiences.



FIG. 1 NMX-VCC-1000 SERENO VIDEO CAMERA

Specifications

NMX-VCC-1000 CAMERA SPECIFICATIONS	
Resolution	Up to 1920x1080@30FPS (Frames Per Second)
Video Format	H.264/MJPEG/YUY2
Audio	Dual MIC for Beam Forming
Max Frame Rate	30fps
Interface	USB 2.0
Field of View	120°
Focus Range	15cm to Infinity
Digital Zoom	4x Digital Zoom
LED	White Power LED
IR Cut Filter	Yes
System Compatibility	Enzo, PCs, and Macs
Power	2.5 Watts, 5V/500mA Maximum via USB Port
Dimensions (H x W x D)	1.72" x 7.48" x 1.52" (43.7mm x 190mm x 38.6mm)
Weight	.4 lbs (.181 kg), .8lbs shipped (.363 kg)

NMX-VCC-1000 Installation

The NMX-VCC-1000 video camera has a reversible, weighted base for table-top mounting or wall/inverted mounting. The camera is mounted to the base using a pivot stem and can be adjusted to virtually any angle. The base has a single bottom screw to enable it to convert from a rubber surface for table-top mounting to a metal side for adhesive mounting or securing to the optional wall-mount kit (FG3211-11). The included USB cable is 5 feet (1.5 meters) long. Take this into consideration when placing the camera in the desired mounting position.

Table-top Mounting

- Place the camera in a position ensuring the best possible range of view. The rubber base stops Sereno from sliding on tabletops.

Wall Mounting

- An optional magnetic adapter is available to mount the Sereno camera onto a wall or solid surface. Order Part number FG3211-11. Refer to the Sereno documentation at <http://www.amx.com/products>.

Under Display Mounting

- Remove the screw in the base plate.
- Remove and flip the insert over and reinstall using the same screw, with the shiny black painted side of the base insert showing.

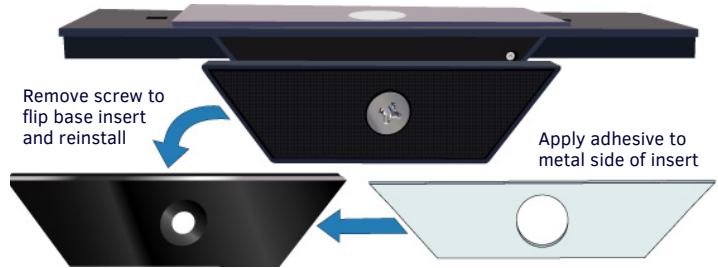

FIG. 2 BASE PLATE INSERT REVERSAL

- Peel and attach the provided double-sided adhesive to the flat side of the base.
- Clean area that the camera will be adhered to with alcohol or similar cleaner.
- Peel the other side of the adhesive and attach the camera to a display. Press and hold for several seconds to ensure a solid bond.
- With the camera mounted upside down, reposition/rotate the camera head so the image will appear correct on the display (AMX logo should be right side up).

Removing Adhesive

To remove the camera, grab it by the base and rotate parallel to the surface it is adhered to. This provides the greatest chance of removing the camera without damaging it or the surface. If this proves difficult, try using monofilament/fishing line or dental floss to separate the adhesive from the mounting surface.

Connecting the NMX-VCC-1000 Camera

The NMX-VCC-1000 receives power over standard USB cabling. No other power connections are needed.

- Route the USB cable from the camera unit to the USB socket on the Enzo, PC or Mac, ensuring that the cable isn't a tripping hazard.
- Plug the USB cable into an available USB port. When power is applied, the white front panel LED will light according to the table below:

LED STATE	CAMERA STATE	DESCRIPTION
Blinking	Powered/ Shutter Closed	If the camera is plugged in and an App is attempting access it with the shutter closed, the LED will continue blinking until the App is closed or the shutter is retracted. During this state, the camera is disabled and microphones are physically disconnected.
Solid	Powered/ Shutter Open	If the camera is plugged in and in use with the shutter open, the LED will remain lit until the App is closed or the shutter is closed, disabling the camera and physically disconnecting the microphones.
Off	Powered Off	If the camera is plugged in and no App is attempting to use it with the shutter in either the closed or open position, the LED will remain off until an App requiring the camera is launched.

Operating the Shutter

When the LED is blinking, an App is attempting to use the camera but the shutter is closed and the camera microphones are electrically disconnected. To open the shutter for camera use, perform the following steps:

- The sliding shutter is at the top rear center of the unit. Refer to FIG. 3.

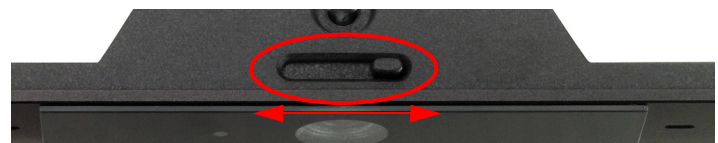

FIG. 3 SHUTTER OPERATION - LEFT TO CLOSE SHUTTER AND RIGHT TO OPEN

- Slide the shutter to the right side and visually verify the lens is now exposed to the room. The LED emit solid white light.

Access this Quick Start Guide online using your mobile device to scan the QR code located on the bottom of the NMX-VCC-1000 Sereno Video Camera package.