

# ELAN Surveillance Cameras

---

## Quick Start Installation Sheet:

**1 page - 1/0**

Format: 11" wide x 8.5" high

**05/11/2018**

Questions? Juergen 707.778.5826

**P/N 10021928 REV. A0**

---

### **PRINTER'S INSTRUCTIONS:**

INK: 1-color - Black

NO. of PAGES: 1

MATERIAL: 80# text - gloss

SCALE: 1:1

Must be RoHS Compliant

**USE ARTWORK ON PAGE 2 of PDF**

# MT-DBB-WH

Dome Camera Back Box (White)

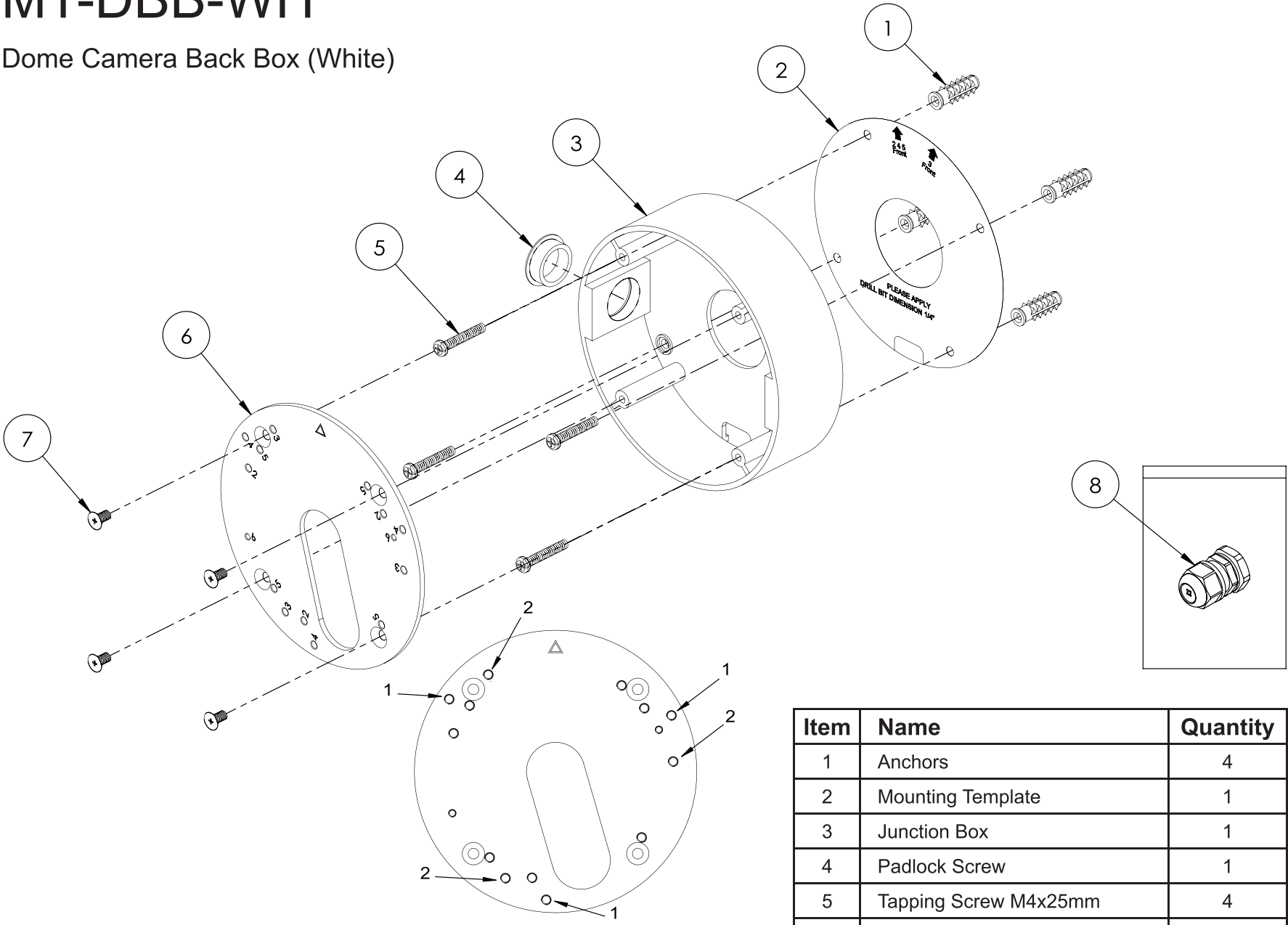

Hole Position Diagram

Hole 1: Varifocal Domes  
Hole 2: Fixed Lens Domes

Item	Name	Quantity
1	Anchors	4
2	Mounting Template	1
3	Junction Box	1
4	Padlock Screw	1
5	Tapping Screw M4x25mm	4
6	Fixed Plate	1
7	Flat Head Screw M4x8mm	4
8	Cable Clands	1

