

Wirepath ONE™ Door

Thank you for purchasing a premium product from Wirepath Structured Wiring. The Wirepath ONE™ Media Door is designed to provide serious flexibility for a professional installation.

A - Surface Mounting

Mount the door to a surface, no tricky leveling. Reverse the swing of the door prior to installation if desired. See back for installation steps.

B - Router Friendly Construction

Made from durable UL Listed ABS plastic to ensure that there is little signal interference when using routers or other wireless devices.

C - Mounting Platform

The platform allows for a flexible configuration. Flip the platform over to raise or lower the height. Additionally, the fixed standoffs allow the platform to swing left or right.

D - Wire Guides

Manage your wires by routing through the wire guides on the side of the platform.

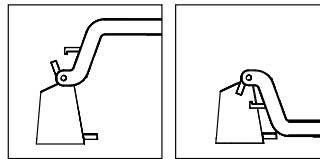

E - Module Attachment Holes

Secure modules with pins or zip ties.

F - Lock & Key

Each door comes equipped with a pre-installed lock and 2 keys to keep prying hands away from equipment inside the enclosure.

G - Plexiglass Window

View the status of a device through the plexiglass window without having to remember to grab the key.

H - Venting and Trunk Line Management

Ventilation is huge. We've already accounted for that with open vents in the bottom and top of the door. Additionally, you may run thick trunk lines through the open vents.

I - Media Enclosure Shelves (not included/shown)

Place shelves (WP-ONE-ENCL-SHELF) wherever you want! The shelves can be mounted on the Mounting Platform on the inside of the door where space is available. If mounting the shelf to a platform, as opposed to the module attachment holes, you may need to press in the center hook to attach it properly.

J - Cross-compatible

All same-size Wirepath Enclosure cans are compatible with this surface mounted door.

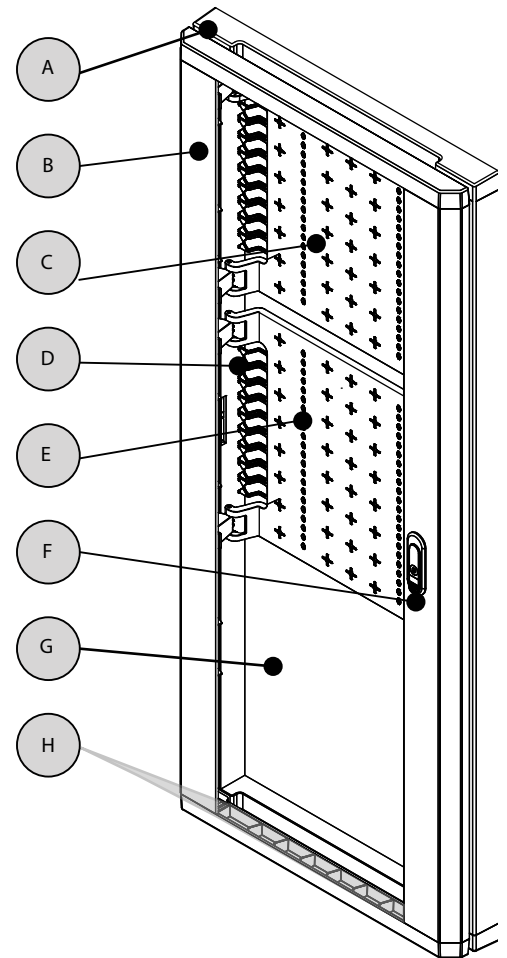

Installation

Tools Needed:

5mm Allen Wrench	#2 Phillips Screwdriver
------------------	-------------------------

1. Locate the desired position over the installed enclosure, leaving enough clearance for the door to swing open in the desired direction. To reverse the swing direction, skip to Swing Direction Reversal below prior to installation.
2. To mount, remove the door first. Unlatch and swing the door open before pulling upward to remove.
3. Ensure the door base is level, and drive a minimum of 4 (14", 20"), or 6 screws (28", 40") into the drywall or plywood through the Surface Mounting Holes of the door base.
4. Reinsert the door's hinges onto the hinge pins, orienting it to swing in the desired direction. To reverse the default direction, follow the directions below.

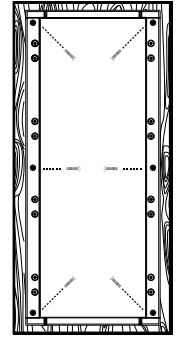

Swing Direction Reversal

ATTENTION: For best practice, determine the direction you would prefer the door to swing prior to installation. Reversing the hinges requires access to the rear of the door base.

1. Open the door, then slide it up and off all hinges.

Size	14 in.	20 in.	28 in.	40 in.
No. of Hinges	2	2	3	4

2. Remove hinge bolts from the rear of the door base with a 5mm Allen Wrench. Turn the hinges laterally so that the hinge pins face the outside of the enclosure.
3. Remove the two screws from the hinge pin receiver bracket on the door with a screwdriver. Swap the hinge pin receiver over to the adjacent slot.
4. Slide the door back onto the hinges. Continue on to reverse the direction of the latch.

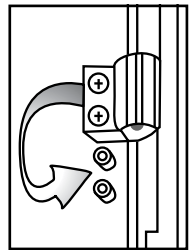
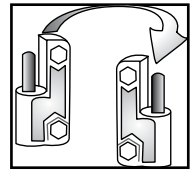

Latch Reversal

1. To remove the door latch (F), remove the clamp with a #2 Phillips screwdriver, and slide the latch out of the door.
2. Rotate the latch mechanism 180° and re-install into latch opening.
3. Loosen the latch plate screw, located behind the latch, and rotate the latch 180° so that it faces the slot in the door. Tighten screw back down once it is in the correct position.

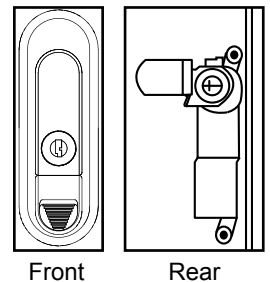

		WP-ONE-DOOR-XX	
Dimensions	14	17.91"W x 15.96"H x 2.94"D	
	20	17.91"W x 21.96"H x 2.94"D	
	28	17.91"W x 29.96"H x 2.94"D	
	40	17.91"W x 41.96"H x 2.94"D	
Hardware Pack			1
2-Position Mounting Platform	14	1	
	20	1	
	28	1	
	40	2	
Material	White ABS Textured Plastic		
Dual Locking	Yes		
UL Listed Material	94V-0		



Limited Lifetime Warranty

This Wirepath Product has a Lifetime Limited Warranty. This warranty includes parts and labor repairs on all components found to be defective in material or workmanship under normal conditions of use. This warranty shall not apply to products that have been abused, modified, or disassembled. Products to be repaired under this warranty must be returned to SnapAV or a designated service center with prior notification and an assigned return authorization number (RA).