

MODEL L-23S DIAGRAM

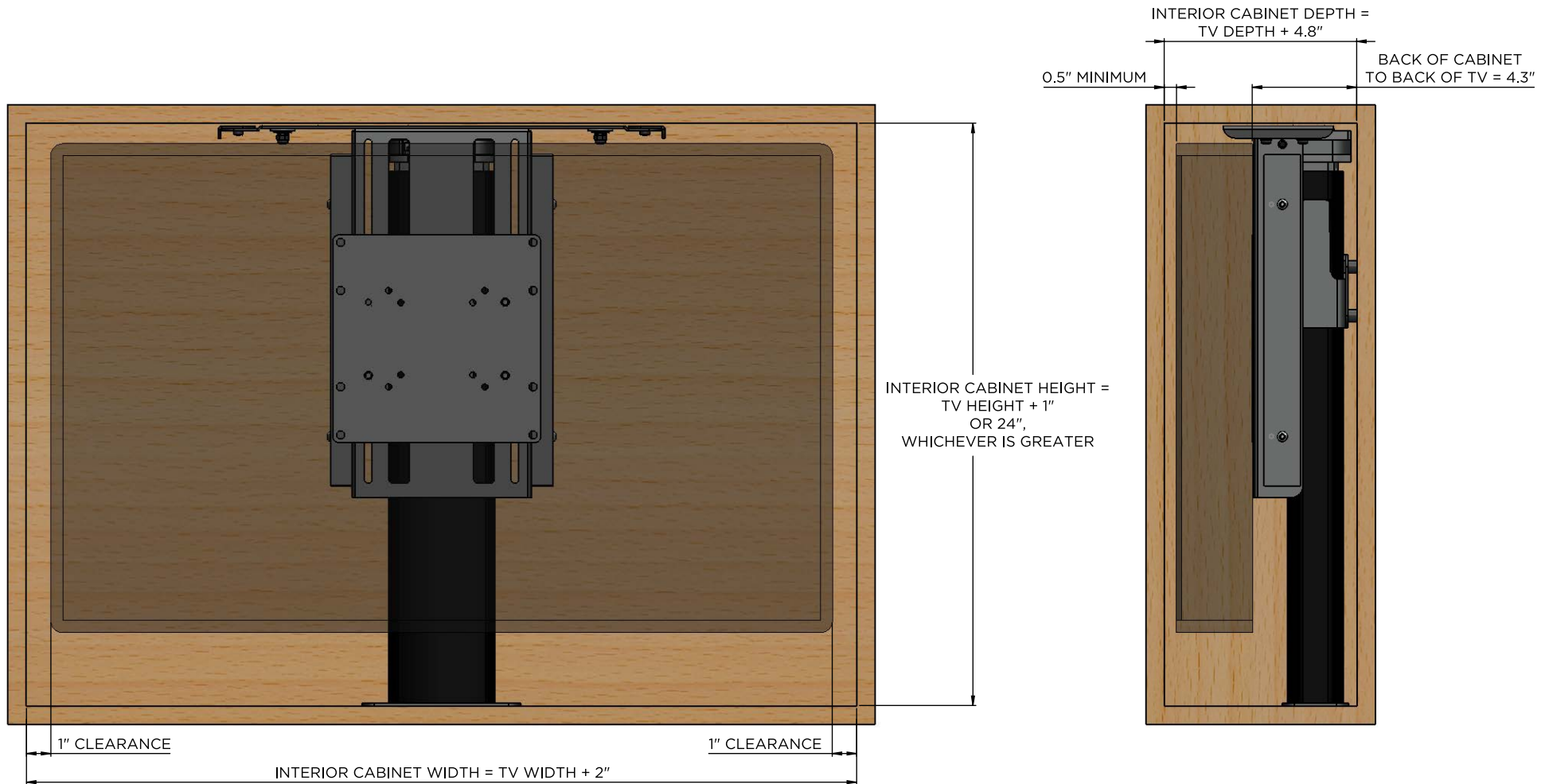

NOTES:

1. THE CABINET BOX SHOWN IN THE DIAGRAM IS FOR REFERENCE ONLY AND IS NOT PROVIDED WITH THE LIFT SYSTEM
2. FOR THIS LIFT MODEL, THE LENGTH OF ITS TRAVEL [EXTENSION LENGTH OR STROKE] IS 23"
3. FOR THIS LIFT MODEL, THE TOTAL WEIGHT CAPACITY IS 130 LBS
4. THIS LIFT MODEL MANUALLY ROTATES 180° IN BOTH DIRECTIONS WITH A LOCKING HOME POSITION
5. LIFT WILL NOT OPERATE WHEN SWIVELED
6. LID IS DESIGNED TO FLOAT WITH PROVIDED TAPERED PINS - LID MUST BE REMOVEABLE FOR SAFETY
7. WHEN DETERMINING TV HEIGHT, ALWAYS USE MANUFACTURER SUPPLIED "TV WITHOUT STAND" HEIGHT
8. LIFT MECHANISM IS POWDERCOATED BLACK STEEL - COLORS IN DIAGRAM ARE FOR CLARITY ONLY

nexus²¹
CONCEALMENT SYSTEMS

COPYRIGHT 2016 - ALL RIGHTS RESERVED
UPDATED 01/06/16