

# MODEL L-27 DIAGRAM WITH HINGED TOP GUIDES

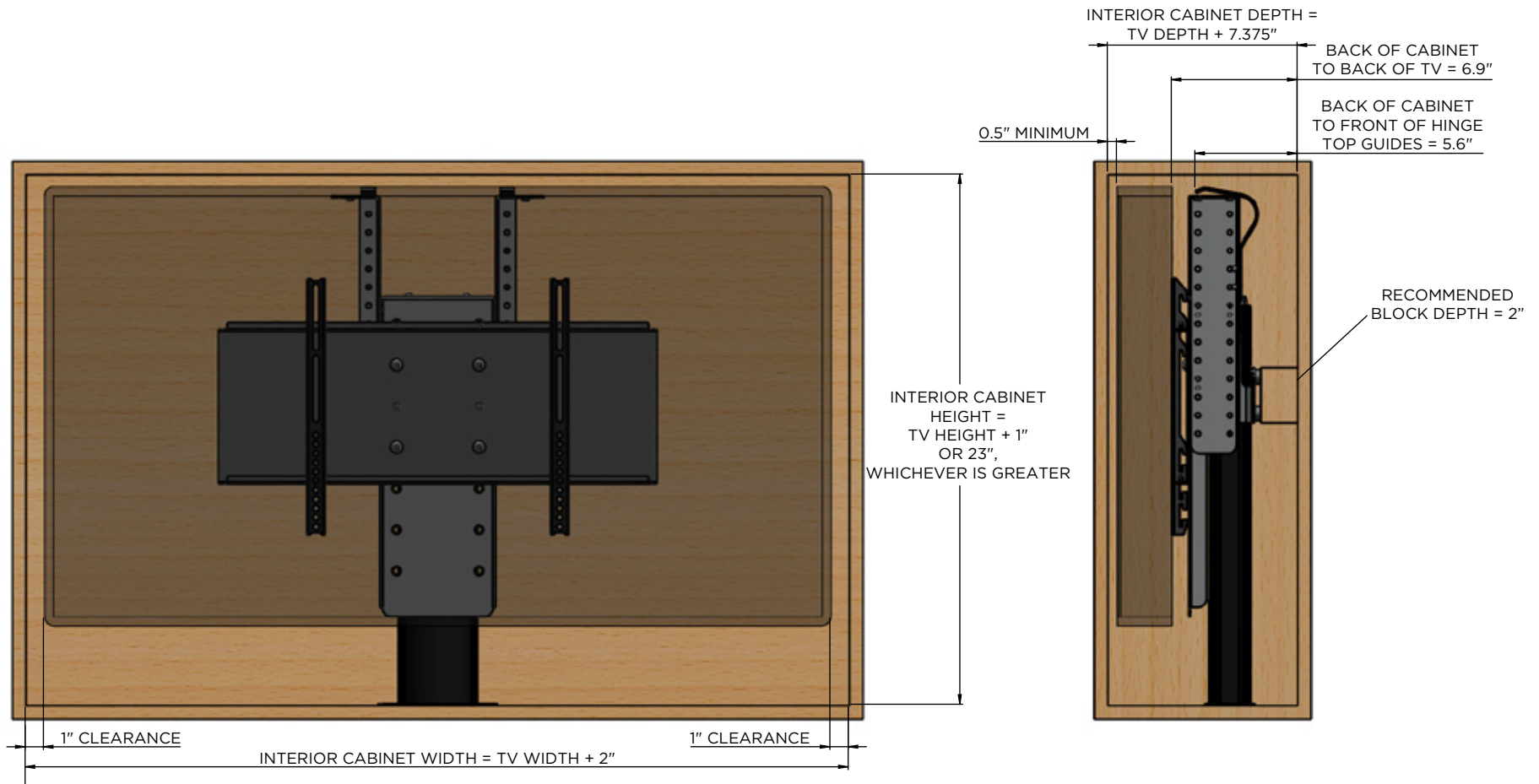

## NOTES:

1. THE CABINET BOX SHOWN IN THE DIAGRAM IS FOR REFERENCE ONLY AND IS NOT PROVIDED WITH THE LIFT SYSTEM
2. FOR THIS LIFT MODEL, THE LENGTH OF ITS TRAVEL [EXTENSION LENGTH OR STROKE] IS 26.5"
3. FOR THIS LIFT MODEL, THE TOTAL WEIGHT CAPACITY IS 130 LBS
4. HEIGHT OF THIS MODEL IS ADJUSTABLE IN 1/2" INCREMENTS UP TO 8" [MINIMUM HEIGHT = 23"; MAXIMUM HEIGHT = 31"]
5. LID IS DESIGNED TO FLOAT WITH PROVIDED TAPERED PINS - LID MUST BE REMOVEABLE FOR SAFETY
6. WHEN DETERMINING TV HEIGHT, ALWAYS USE MANUFACTURER SUPPLIED "TV WITHOUT STAND" HEIGHT
7. LIFT MECHANISM IS POWDERCOATED BLACK STEEL - COLORS IN DIAGRAM ARE FOR CLARITY ONLY

## IMPORTANT HINGED LID INFORMATION

1. HINGED LIDS REQUIRE THE USE OF THE "HINGED TOP GUIDE" ACCESSORY. THESE GUIDES ARE MOUNTED ON THE TOP OF THE LIFT SYSTEM AND WILL PUSH THE LID OPEN AS THE LIFT EXTENDS. WHEN THE LIFT IS LOWERED, THE LID CLOSES BY GRAVITY. PLEASE NOTE: THE LID MUST NOT OPEN BEYOND 90 DEGREES.
2. HINGES FOR THE LID ARE NOT PROVIDED BY NEXUS 21
3. FOR THE HINGED LID TO FUNCTION PROPERLY YOU MUST ALLOW AT LEAST 2" OF SPACE BETWEEN THE PIVOT POINT OF THE HINGE AND THE BACK OF THE LIFT SYSTEM. PLEASE BE AWARE SOME HINGE STYLES - SUCH AS EUROPEAN HINGES - MAY INCREASE THE OVERALL DEPTH THAT IS REQUIRED INSIDE THE CABINET. PLEASE CALL US IF YOU HAVE ANY QUESTIONS.

**nexus**<sup>21</sup>  
CONCEALMENT SYSTEMS

COPYRIGHT 2016 - ALL RIGHTS RESERVED  
UPDATED 01/18/16