

MODEL L-27S DIAGRAM

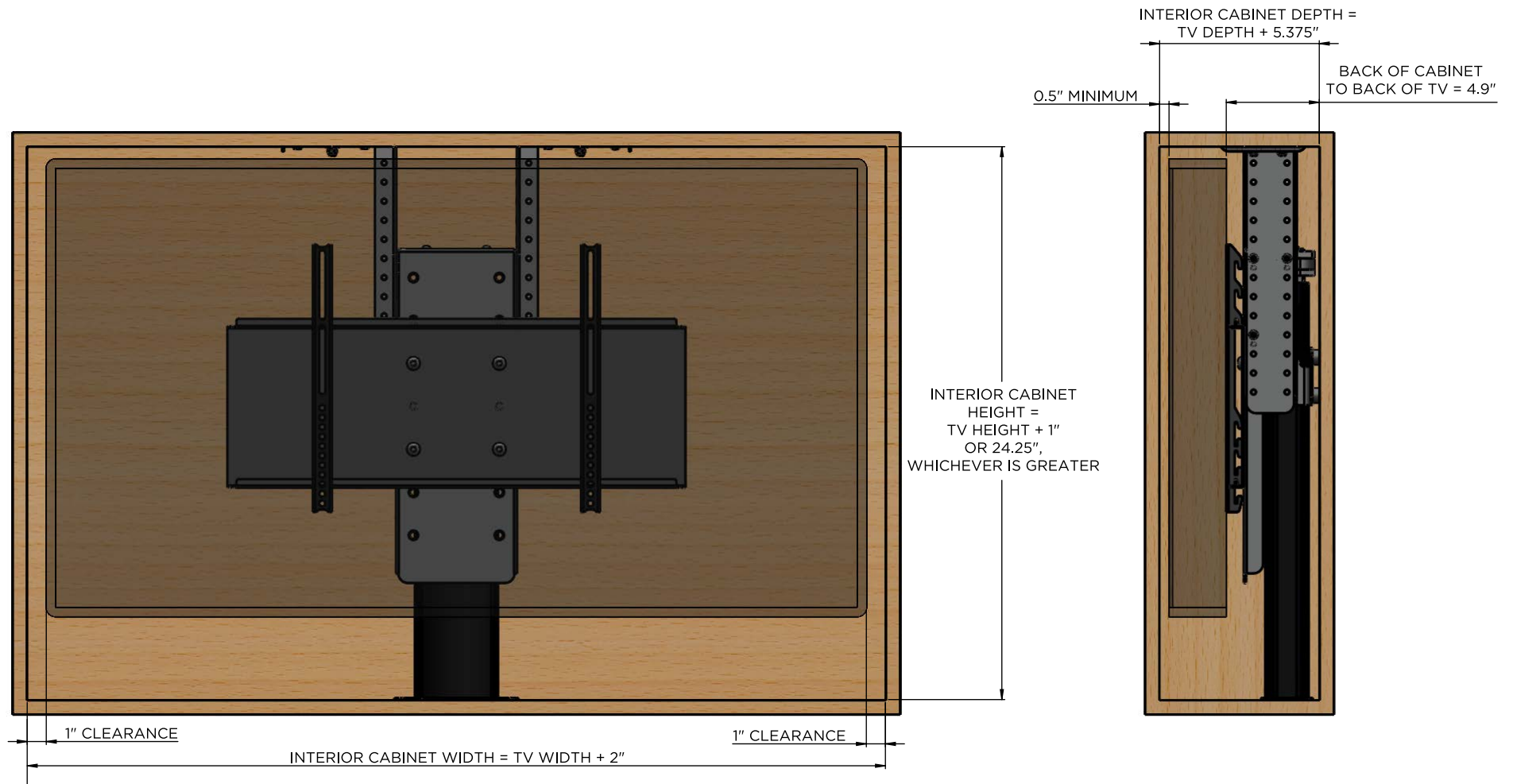

NOTES:

1. THE CABINET BOX SHOWN IN THE DIAGRAM IS FOR REFERENCE ONLY AND IS NOT PROVIDED WITH THE LIFT SYSTEM
2. FOR THIS LIFT MODEL, THE LENGTH OF ITS TRAVEL [EXTENSION LENGTH OR STROKE] IS 26.5"
3. FOR THIS LIFT MODEL, THE TOTAL WEIGHT CAPACITY IS 130 LBS
4. THIS LIFT MODEL MANUALLY ROTATES 180° IN BOTH DIRECTIONS WITH A LOCKING HOME POSITION
5. LIFT WILL NOT OPERATE WHEN SWIVELED
6. HEIGHT OF THIS MODEL IS ADJUSTABLE IN 1/2" INCREMENTS UP TO 8" [MINIMUM HEIGHT = 24.25"; MAXIMUM HEIGHT = 32.25"]
7. LID IS DESIGNED TO FLOAT WITH PROVIDED TAPERED PINS - LID MUST BE REMOVEABLE FOR SAFETY
8. WHEN DETERMINING TV HEIGHT, ALWAYS USE MANUFACTURER SUPPLIED "TV WITHOUT STAND" HEIGHT
9. LIFT MECHANISM IS POWDERCOATED BLACK STEEL. COLORS IN DIAGRAM ARE FOR CLARITY ONLY.

nexus²¹
CONCEALMENT SYSTEMS

COPYRIGHT 2016 - ALL RIGHTS RESERVED
UPDATED 05/06/16