

NEXUS₂₁

TECHNOLOGY IN MOTION

Installation Manual for XL-85s with HTG

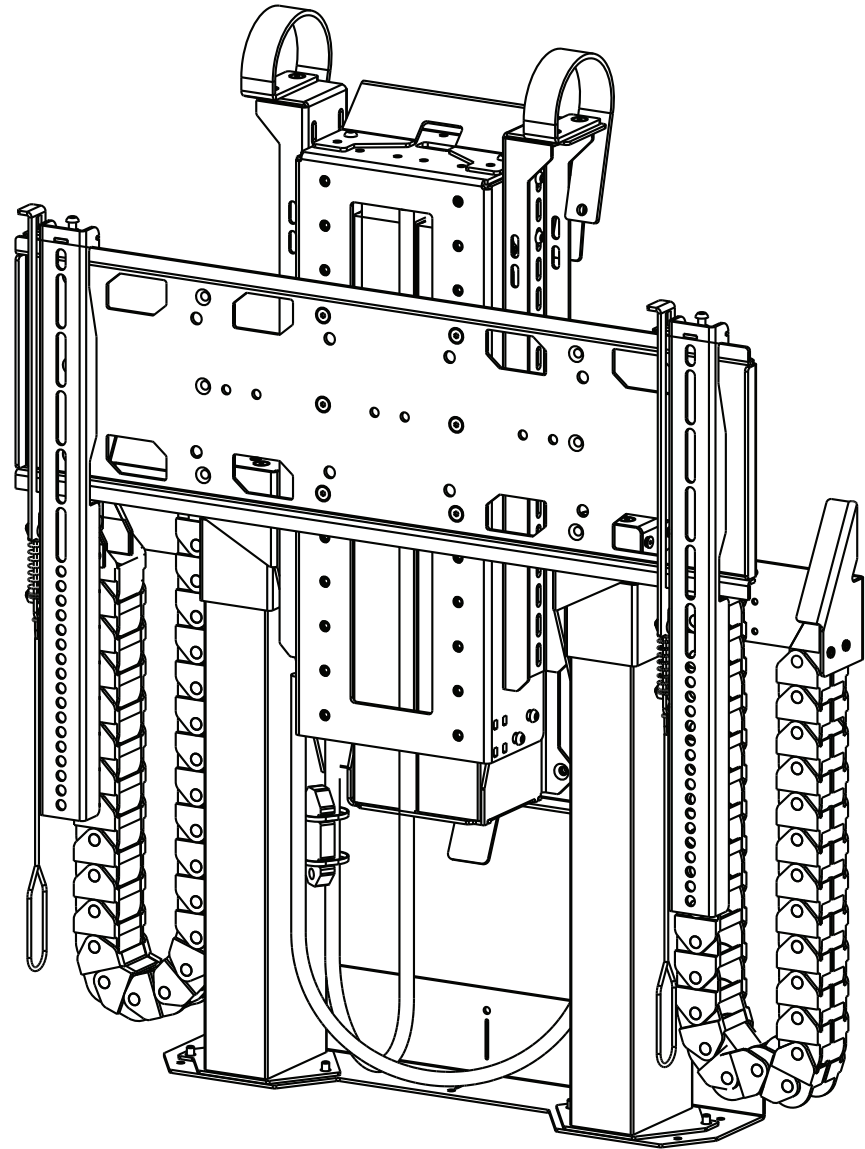

Table of Contents

Safety Information	3
Parts & Hardware List	4
Warranty & Return Policies	6
Lower Actuation System	9
Lower Cable Management	16
Upper Actuation System	21
Upper Cable Management	26
Hinged Lid Setup	34
TV Mounting	37

Safety Information

WARNINGS:

1. Do not use this product for any application other than those specified by Nexus 21.
2. Do not exceed the weight capacity. This can result in serious personal injury or damage to the equipment. It is the installer's responsibility to ensure that the total combined weight of all attached components does not exceed that of the maximum figure stated.
3. Follow all technical specifications and instructions during the installation.
4. Only use attachments/accessories specified by the manufacturer.
5. Close supervision is necessary when this system is being used by, or near, children, or disabled persons.
6. It is the responsibility of the installer to warn all potential users of the dangers of interfering with the mechanism during operation.
7. Read all technical instructions fully before installation and use. It is the installer's responsibility to ensure that all documentation is passed on to the users and read fully before operation.
8. Failure to provide adequate structural strengthening, prior to installation can result in serious personal injury or damage to the equipment.
9. Risk of electric shock. Do not attempt to open the Control Box.
10. To reduce risk of fire or electric shock, do not expose parts to rain or other liquids.
11. Protect the power cord from being walked on or pinched.
12. Keep all documentation.
13. Heed all warnings.
14. Clean only with a dry cloth.
15. Refer all service questions to Nexus 21 if the system does not operate normally.

Safety Notice: Avoid contact with the TV and Lift System during operation. The lid of your enclosure must be installed as described in the instructions, using the Lid Attachment Pins. Installing the enclosure lid in any other fashion will create hazardous pinch points that can cause serious personal injury. Do not, under any circumstances, allow any person or pet to position themselves underneath the TV at anytime.

Disclaimer: Nexus 21 disclaims any liability for modifications, improper installations, or installations over the specified weight range. Nexus 21 will not be liable for any damages arising out of the use of, or inability to use, Nexus 21 products. Nexus 21 bears no responsibility for incidental or consequential damages. This includes, but is not limited to, any labor charges for the servicing of Nexus 21 products performed by anyone other than Nexus 21. Nexus 21 intends to make this and all documentation as accurate as possible. However, Nexus 21 makes no claim that the information contained herein covers all details, conditions or variations, nor does it provide for every possible contingency in connection with the installation or use of this product. The information contained in this document is subject to change without prior notice or obligation of any kind. Nexus 21 makes no representation of warranty, expressed or implied, regarding the information contained herein. Nexus 21 assumes no responsibility for accuracy, completeness or sufficiency of the information contained in this document.

Parts & Hardware List

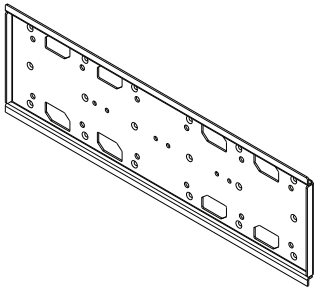

Screen Back Plate

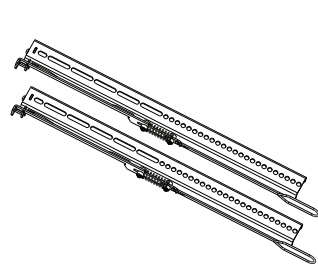

(2) Vertical Mounting Bars



HTG Sled

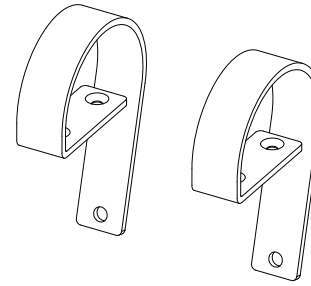

(2) Curved HTG Brackets

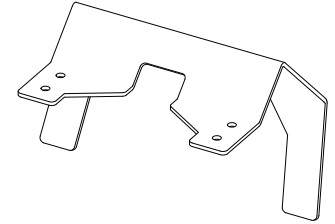

Large HTG Bracket

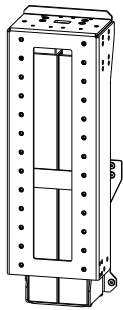

Upper Assembly

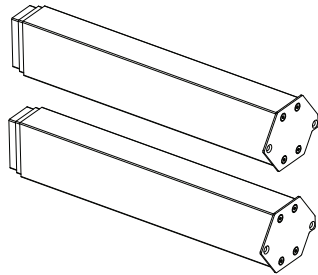

(2) Lower Lift Columns

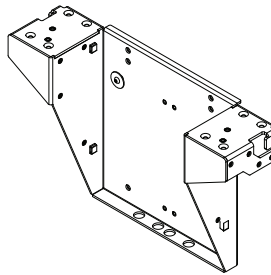

Center Riser Bracket

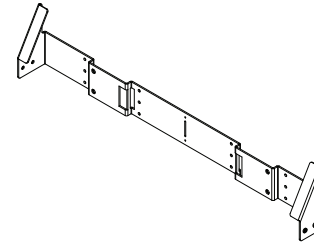

Rear Support Bracket

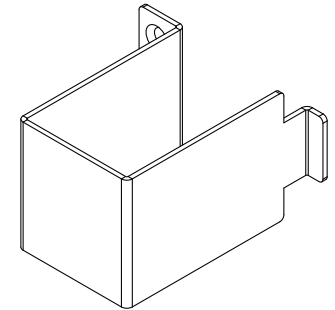

(2) Lower Column Clamps

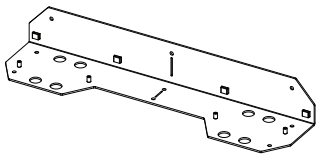

Base Mount

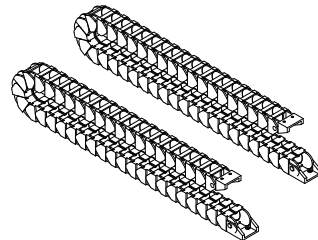

(2) Lower Cable Track

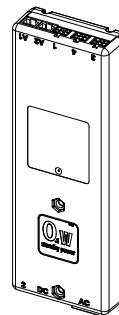

Control Box

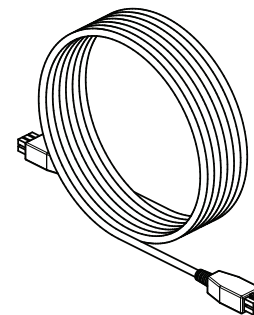

(2) 4.5m Motor Cables

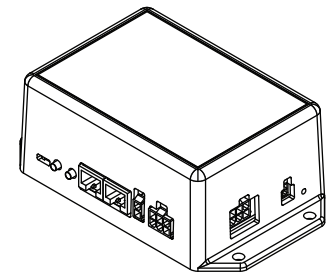

Universal Control Hub

Parts & Hardware List

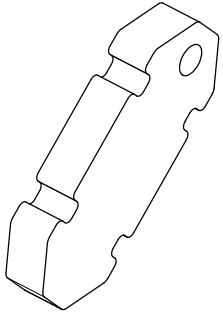

(2) Cable Weight

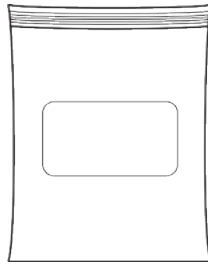

Control Kit

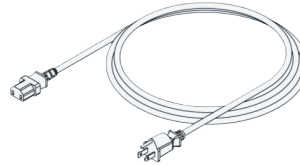

Power Cord

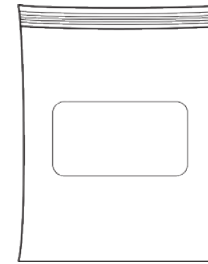

**Hardware Pack
(See Contents List Below)**

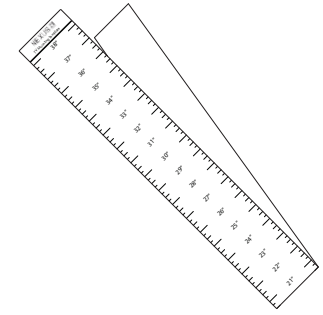

TV Mounting Template

Hardware Pack Contents:

M5 x 12 FHMS (8)
#8 X 3/4" FHWS (10)
1/4" Flat Washer (4)
Zip Tie (12)

M6 x 12 FHMS (20)
#10 X 1 3/4" FHWS (2)
Lid Attachment Pin (2)
Snakeskin Tie (2)

M6 x 20 FHMS (8)
#10 X 3/4" THWS (21)
3mm Hex Key (1)
M5 x 6 FHMS (4)

M6 x 10 BHMS (22)
M6 Thumb Screw (4)
4mm Hex Key (1)

M6 x 20 BHMS (2)
M6 Lock Washer (4)
Large Assorted TV Hardware

*Large Assorted TV Hardware accommodates most TV's but additional hardware may be necessary to mount certain TV's.

Return Policy

Within 30 Days of Delivery:

Customers may return a Nexus 21 product(s) for any reason within 30 days of the date it is received for a full refund of the purchase price. Shipping charges associated with your order are not eligible for refund. To initiate a product-return request, please review the following conditions:

- The product must be unused and complete. Full or partial assembly of the product may void eligibility for return.
- The product must be returned in its original packaging to ensure it is not damaged during shipping.
- Customers must call Nexus 21 and speak with a representative to initiate a return request.
- All returns are subject to an inspection process by a member of Nexus 21 Product Support before a refund is issued.
- Please allow a minimum of 2 weeks from the date the return is received for a refund to be processed.
- Any Nexus 21 product that is received back and deemed unfit for resale or restock upon inspection due to installation or shipping damage will not be eligible for a full refund.
- Customers are responsible for shipping charges to send the product back to us.
- All returns must be processed back to the original form of payment used in the purchase of the item(s).

Nexus 21 ships each product encased in custom die-cut foam, which is purpose-engineered for vibration dampening to reduce any risks of shipping damage. It is mandated that all product returns be shipped back to Nexus 21 in their original packaging. If you do not have the original packaging, please contact Nexus 21 Product Support at 1-480-306-5462. A new set of packaging materials can be requested and the cost will be deducted from the refund amount.

After 30 Days

Returns received 30-60 days after the product has been delivered are not eligible for a full refund of the purchase price. All returns accepted back during this time frame will be subject to a **restocking fee of 25% of the original purchase price**. The following conditions apply to any returns received within this stated timeframe:

- The product must be unused and complete. Full or partial assembly of the product may void eligibility for return.
- The product must be returned in its original packaging to ensure it is not damaged during shipping.
- Customers must call Nexus 21 and speak with a representative to initiate a return request.
- All returns are subject to an inspection process by a member of Nexus 21 Product Support before a refund is issued.
- Please allow a minimum of 2 weeks from the date the return is received for a refund to be processed.
- Any Nexus 21 product that is received back and deemed unfit for resale or restock upon inspection due to installation or shipping damage will not be eligible for a full refund.
- Customers are responsible for shipping charges to send the product back to us.
- All returns must be processed back to the original form of payment used in the purchase of the item(s).

Nexus 21 ships each product encased in custom die-cut foam, which is purpose-engineered for vibration dampening to reduce any risks of shipping damage. It is mandated that all product returns be shipped back to Nexus 21 in their original packaging. If you do not have the original packaging, please contact Nexus 21 Product Support at 1-480-306-5462. A new set of packaging materials can be requested and the cost will be deducted from the refund amount.

Nexus 21 will not accept return requests past 60 days of the product being delivered.

To initiate a Return follow the steps listed below:

Step 1: Call 1-888-981-9919 and request to return your product(s).

Step 2: Your Account Manager will provide you with a link to a form for you to fill out digitally.

Step 3: Arrange shipment of the product to our office. Emailing the tracking information to support@nexus21.com can expedite the process.

Once your product is received, please allow up to 2 weeks for us to inspect and process your return. You will receive a confirmation email indicating that your return has been successfully processed. Refunds may take 5 - 10 business days depending on your issuing bank.

10-Year Full Replacement Warranty

Nexus 21 products are manufactured to the highest standards of quality and we are proud to provide the industry's longest, most comprehensive warranty: 10 years of full-replacement coverage.*

Nexus 21's dedicated product-support specialists are ready to assist you with any questions. We ask that our specialists be consulted before any repairs or modifications are attempted, as these may void the product warranty.

How It Works:

Step 1:

If you experience any problem with a Nexus 21 system, call our Product-Support Team at 1-480-306-5462.

Step 2:

We'll guide you through some of our basic troubleshooting procedures to help identify any issues. The majority of reported issues are resolved with us on the first call without a need for replacement parts or systems.

Step 3:

In the event that you do need a replacement part or system, we'll ship it to you right away, along with a prepaid UPS return shipping label and a package for the defective part or system to be returned to our office. Nexus 21 will cover the shipping cost of the replacement part or system within the continental United States and Canada (excludes Hawaii, Alaska and Puerto Rico). Shipping costs for replacement parts or systems shipped internationally will be covered up to a value of \$50. Any additional shipping costs, including applicable duties and taxes, are the responsibility of the customer or receiving party.

The Details:

Nexus 21 warrants all systems to be free from defects in material and workmanship from the date of purchase until the end of the coverage period (shown below). The warranty includes all parts, motorized components, electronics and metal parts. If a Nexus 21 system or part proves to be defective in material or workmanship during the expressed warranty period, Nexus 21 will replace it free of charge. If the exact original purchase product is not available (due to upgraded designs or discontinuation of a model), the defective product will be replaced with a similar product of equal or greater value. The replacement will then be covered by the balance of the time remaining on the customer's original warranty. A Nexus 21 product-support representative will determine whether a part or an entire system should be replaced.

* Coverage periods for the warranty are as follows:

Residential and Hotel Use

- All Nexus 21 motorized products (except Apex): 10 years
- Apex Motorized Wall Mount: 5 years

Commercial and Educational Use

- All Nexus 21 motorized products (except Apex): 5 years
- Apex Motorized Wall Mount: 3 years

The Nexus 21 full-replacement warranty does NOT cover: any product on which the serial number has been defaced, modified or removed; damage, deterioration or malfunction resulting from accident, misuse, neglect, power surges, fire, water, lightning or other acts of nature; unauthorized product modification; failure to follow manufacturer's recommended installation instructions supplied with the Nexus 21 system; repair or attempted repair by anyone not authorized by Nexus 21; causes external to the product such as electric power fluctuations or failure; use of supplies or parts not meeting Nexus 21 specifications or any other cause which does not relate to a product defect.

PLEASE NOTE: In order for any warranty claim to be covered fully under the outlined policy we will require the name, company name or contact information for the original purchaser of the product to qualify the claim. If the information requested cannot be supplied to us or located on file, replacement parts or systems may not be covered under warranty.

WARNING: BEFORE YOU BEGIN

IMPORTANT NOTE:

This system must be spaced a minimum of 3" away from the pivot point of the Lid. Failure to space the system may result in damage the cabinet and/or system.

Reference the Dimensional Drawing provided by your Account Manager or found on our website for more details.

Lower Actuation System

Before you begin, consult the Dimensional Drawing for your lift system to ensure your cabinet dimensions are correct and ready for install.

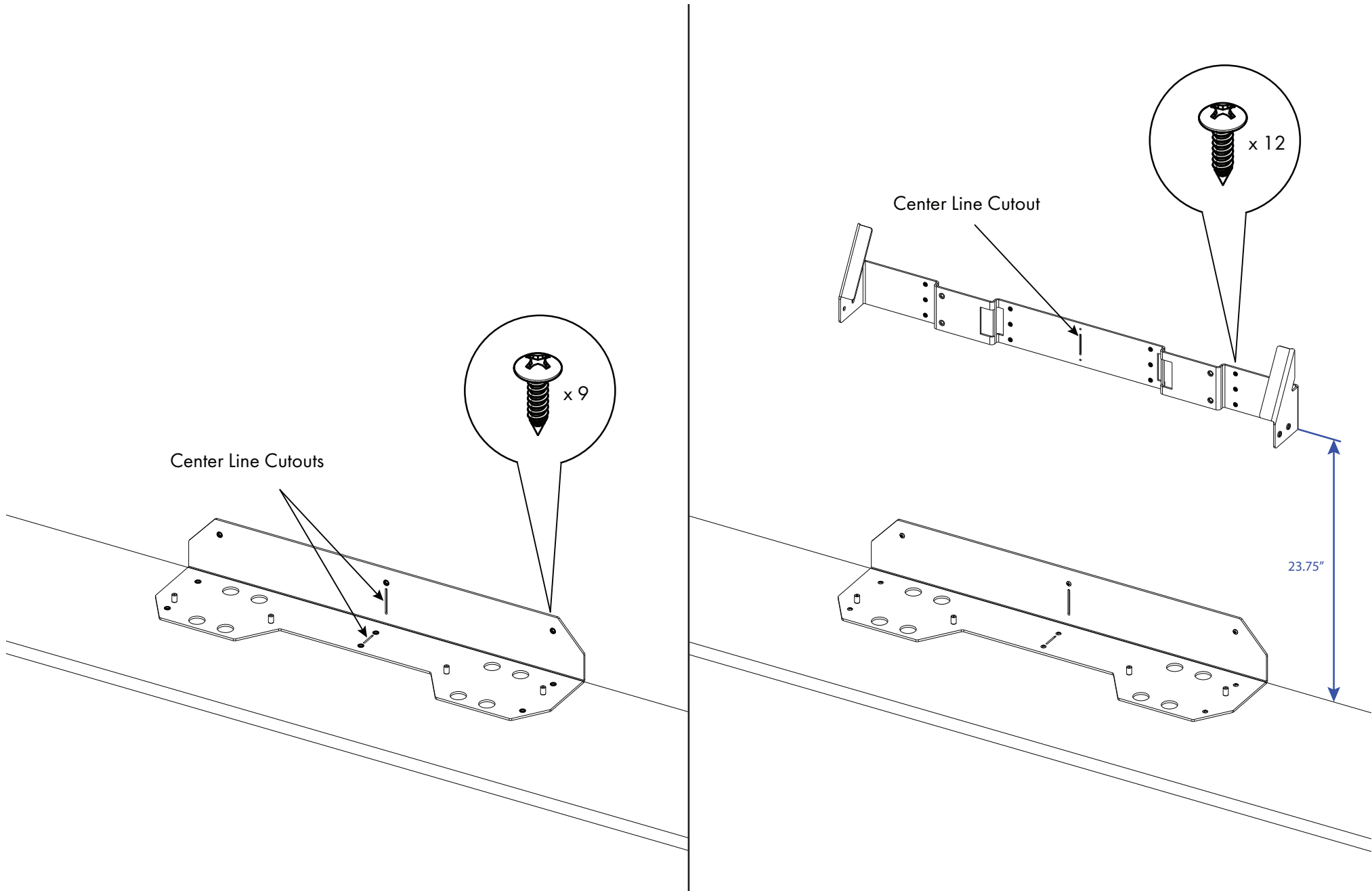

1a. Attach the Base Mount to the base and rear panels of the cabinet using (9) #10 x $\frac{3}{4}$ " THWS.

1b. Attach the Rear Support to the rear panel of your cabinet, so that it is 23.75" from the base panel, using (12) #10 x $\frac{3}{4}$ " THWS.

Note: Use the center line cutouts on the Base Mount and Rear Support to assist with locating them inside your cabinet.

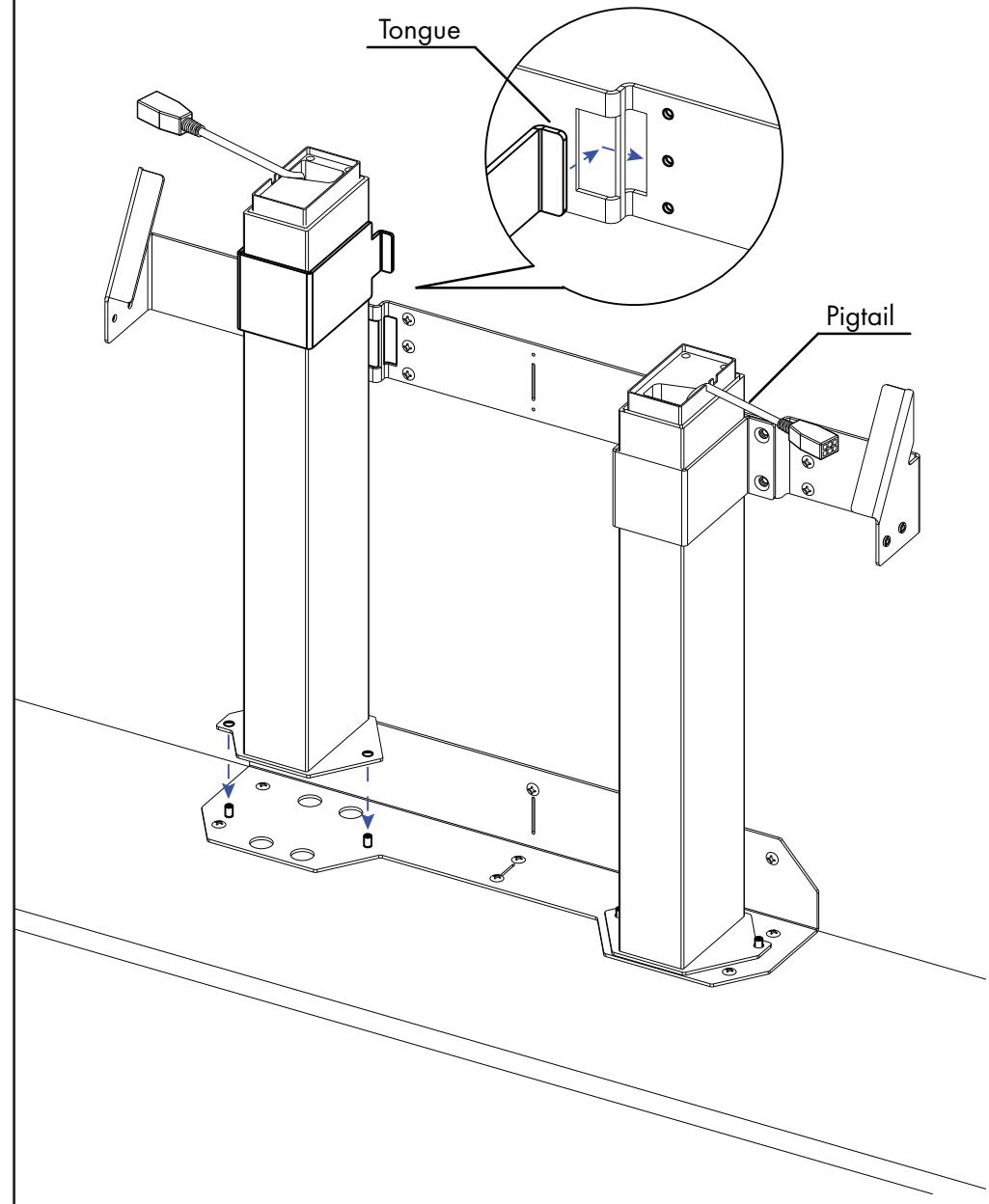
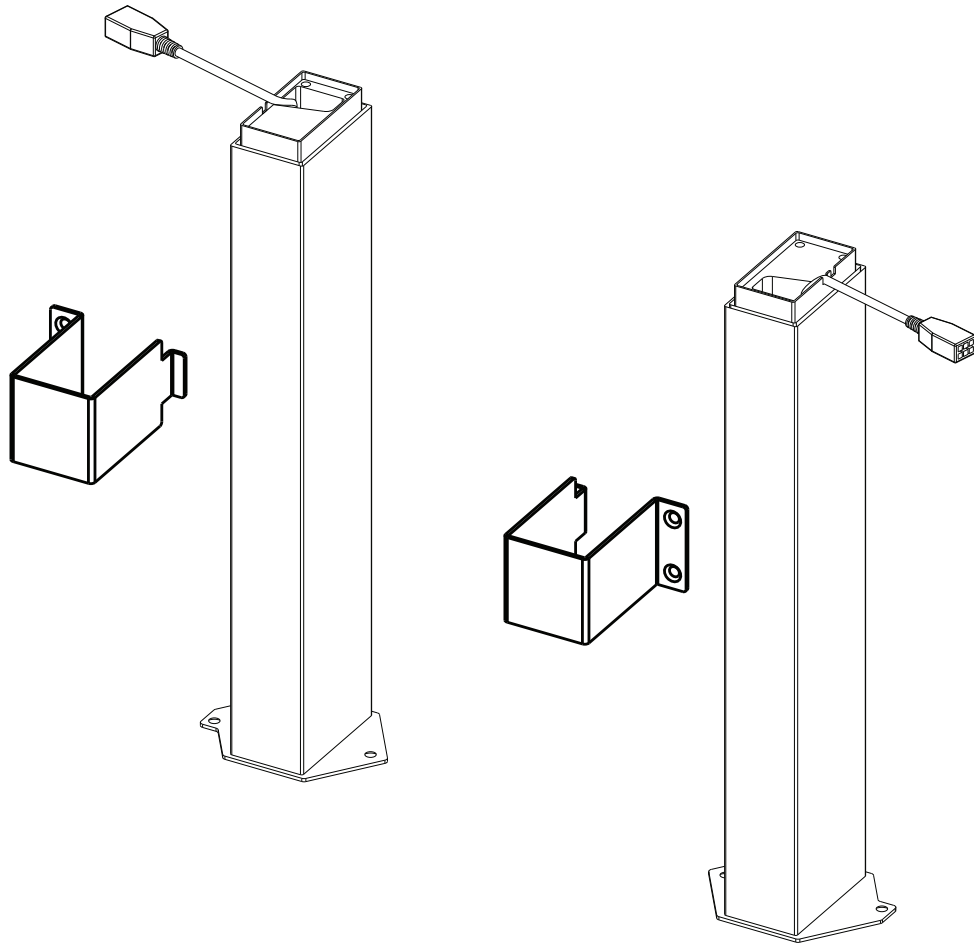

2a. Slide Lower Column Clamps around the Lower Column Assemblies with the holes on the outside, then seat the pigtails as shown above for each column.

2b. Slide Lower Column Assemblies onto Base Mount Studs with the Pigtails facing outwards.

2c. Maneuver Lower Column Assemblies to place tongue of the Lower Column Clamps into their respective slots on the Rear Support.

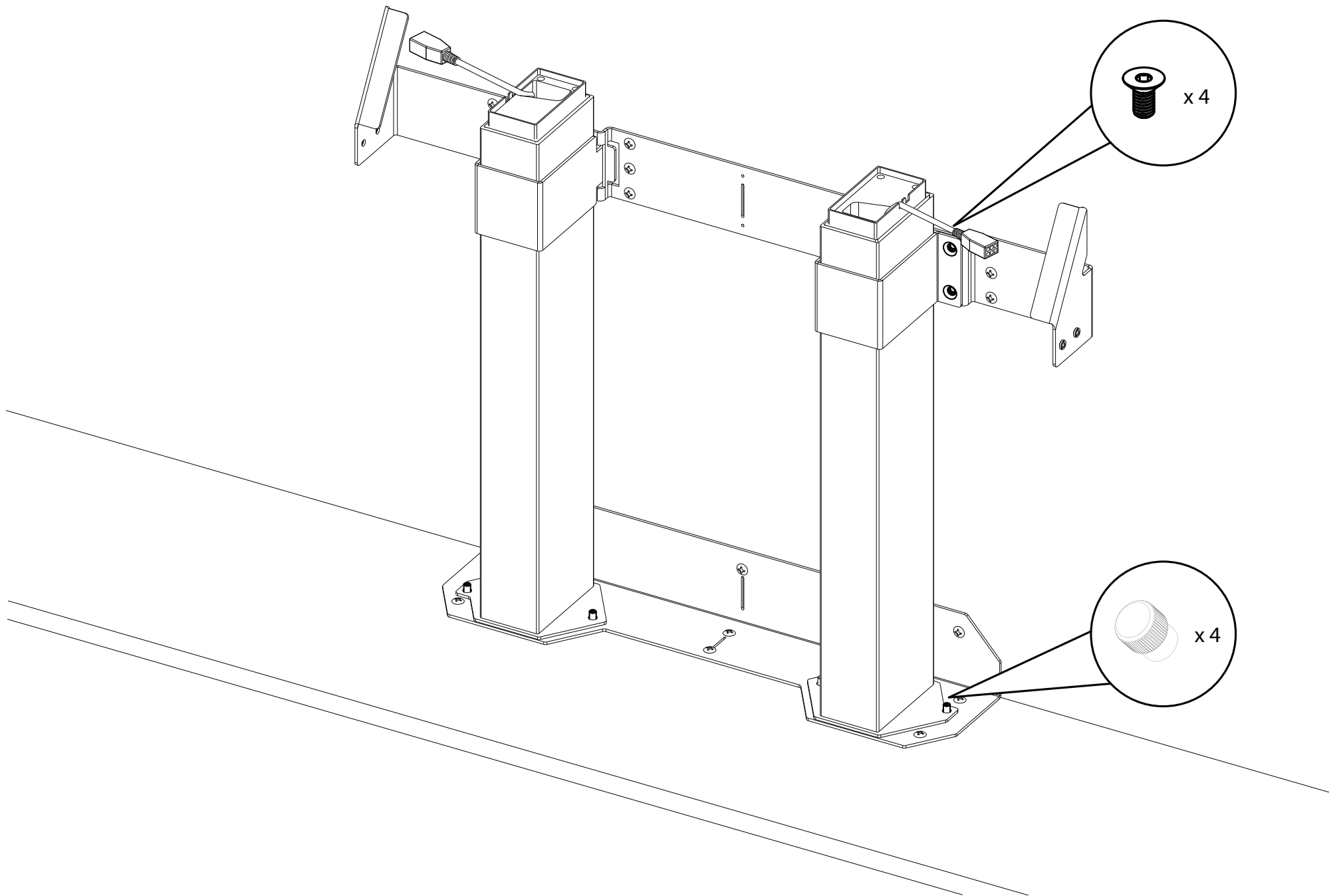

3a. Attach Lower Column Clamps to Rear Support using (4) M6 x 12mm FHMS.

3b. Attach the Lower Column Assemblies to the Base Mount using (4) M6 Thumb Screws.

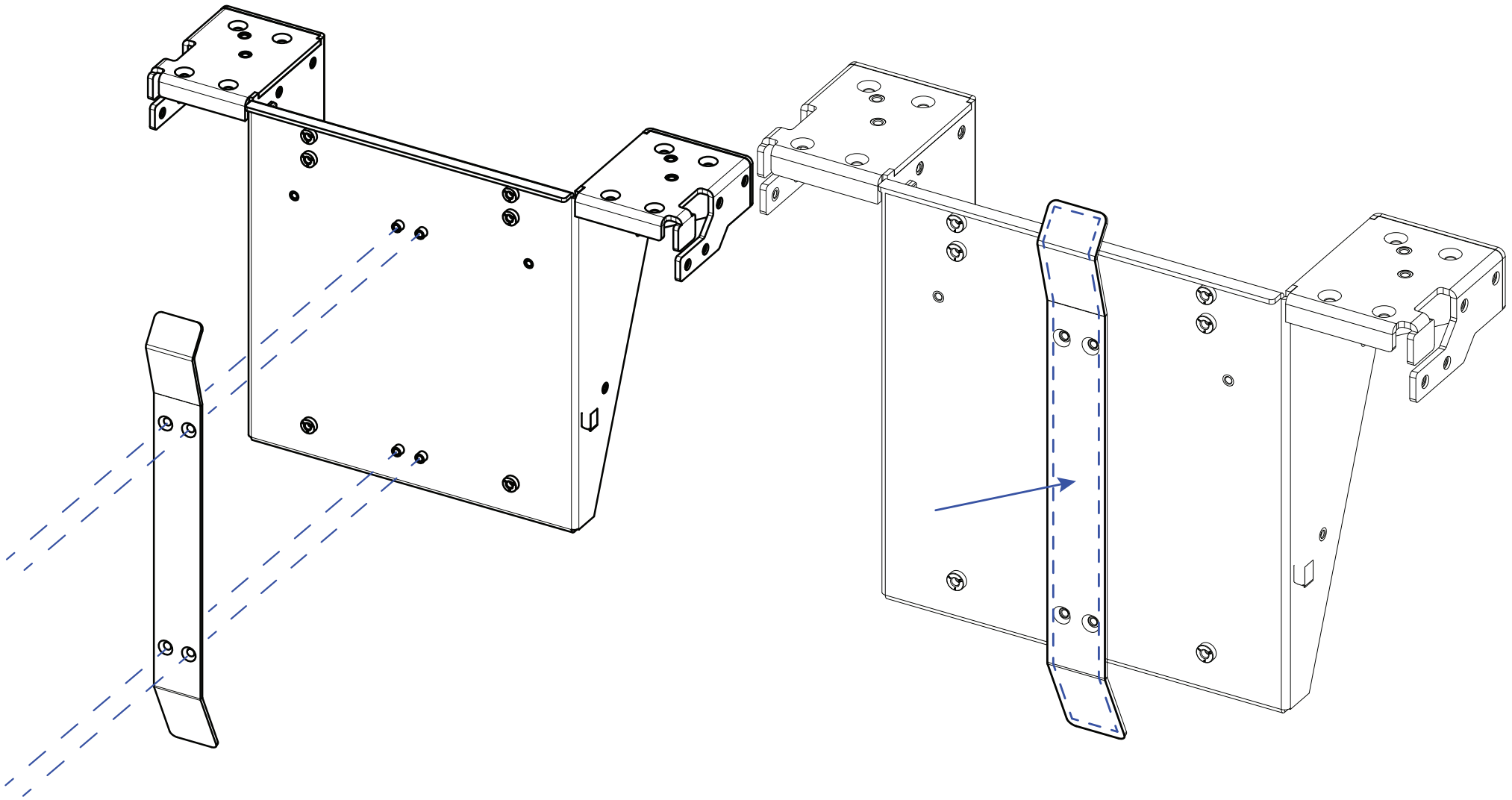

4a. Attach the HTG Sled to the Center Riser using (4) M5 x 6 FHMS.

4b. Apply the Velcro Loop Strip to the back of the HTG Sled as shown in the image above.

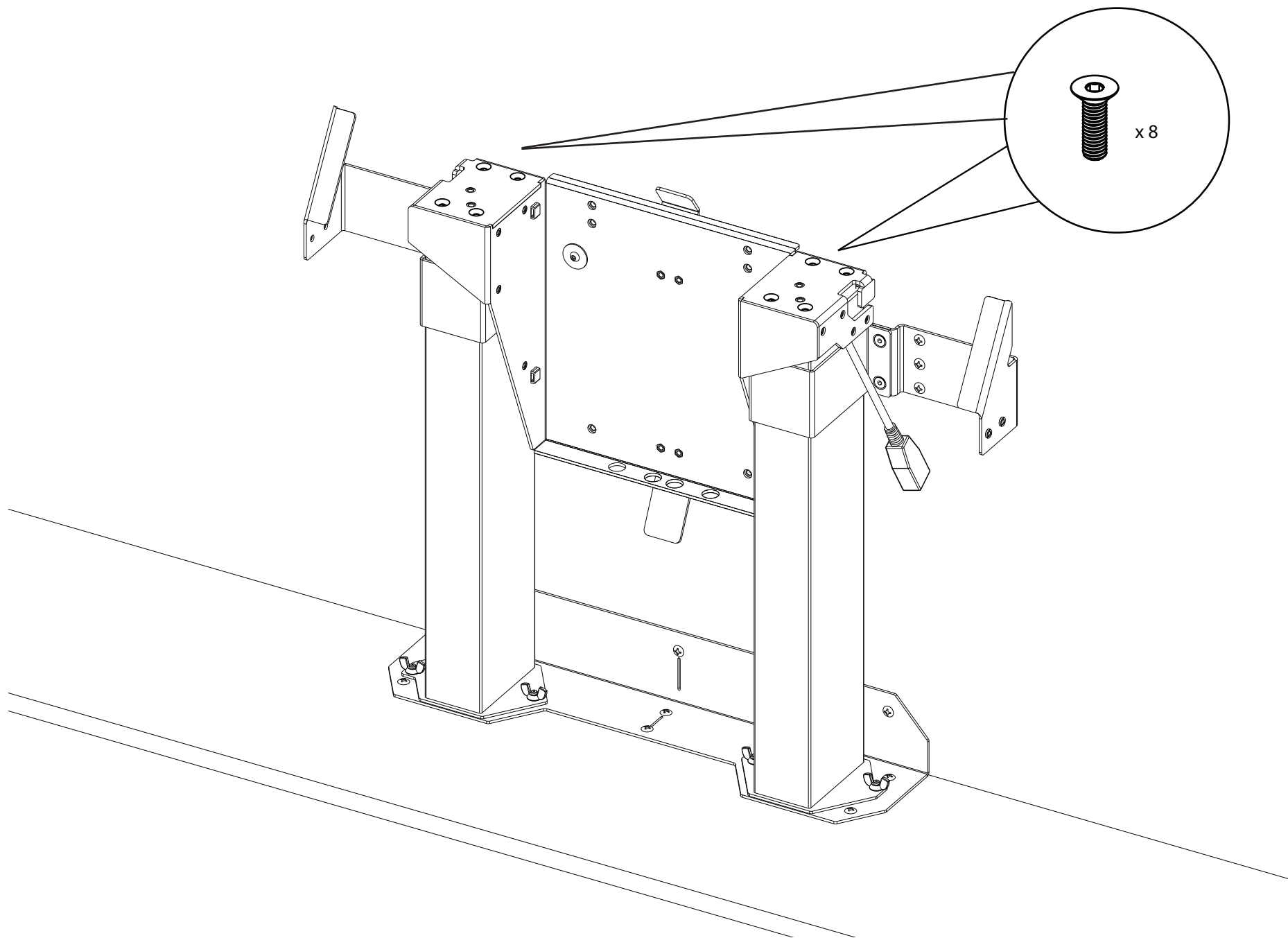

4. Place the Center Riser on top of the Lower Column Assemblies and attach it using (8) M6 x 20 FHMS.

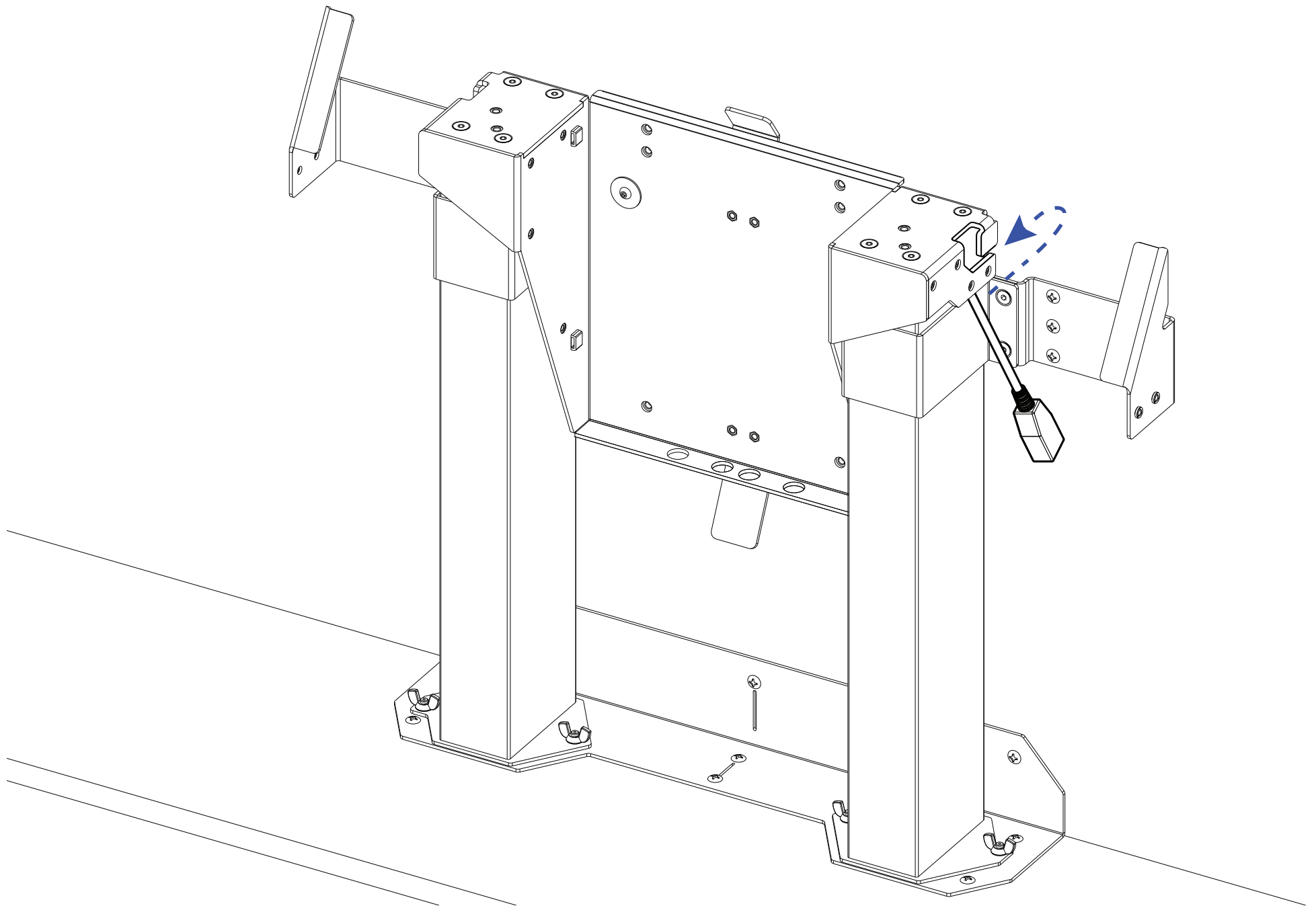

5. Manuever the Lower Column Pigtails into the slots on the left and right sides of Center Riser.

Lower Cable Management

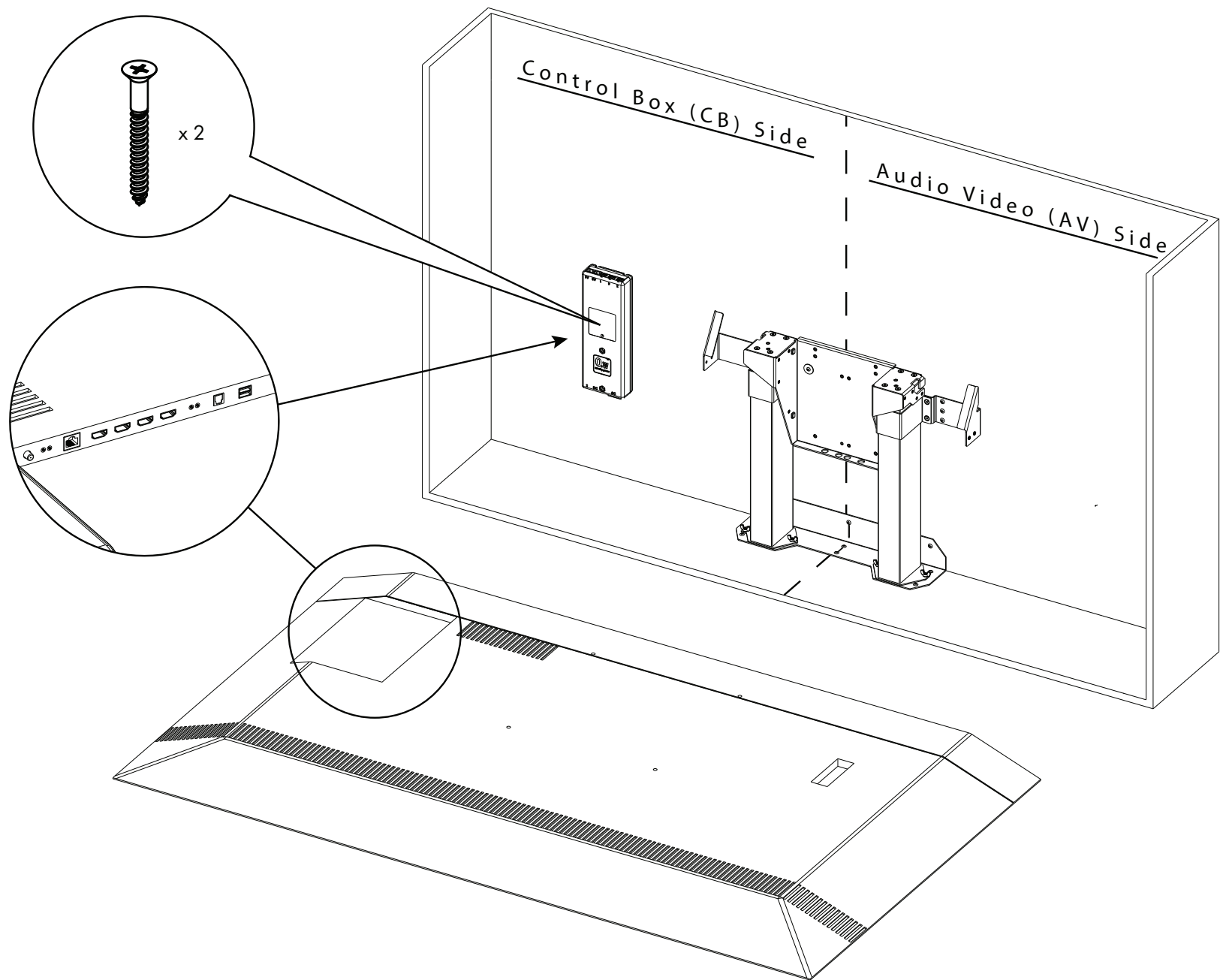

6a. Identify which side the AV ports are on for your TV.

6b. Mount the Control Box to the interior of the cabinet on the same side as your AV Ports, using (2) #10 x 1-3/4" FHWS.

Important Note: This manual will refer to the side of the cabinet with your Control Box as the **CB Side**. The other side will be referred to as the **AV Side** since this will be where all of your AV Cables end up after they've been managed. For illustration purposes, the rest of this manual will show an installation with the **CB Side** on the left and **AV Side** on the right.

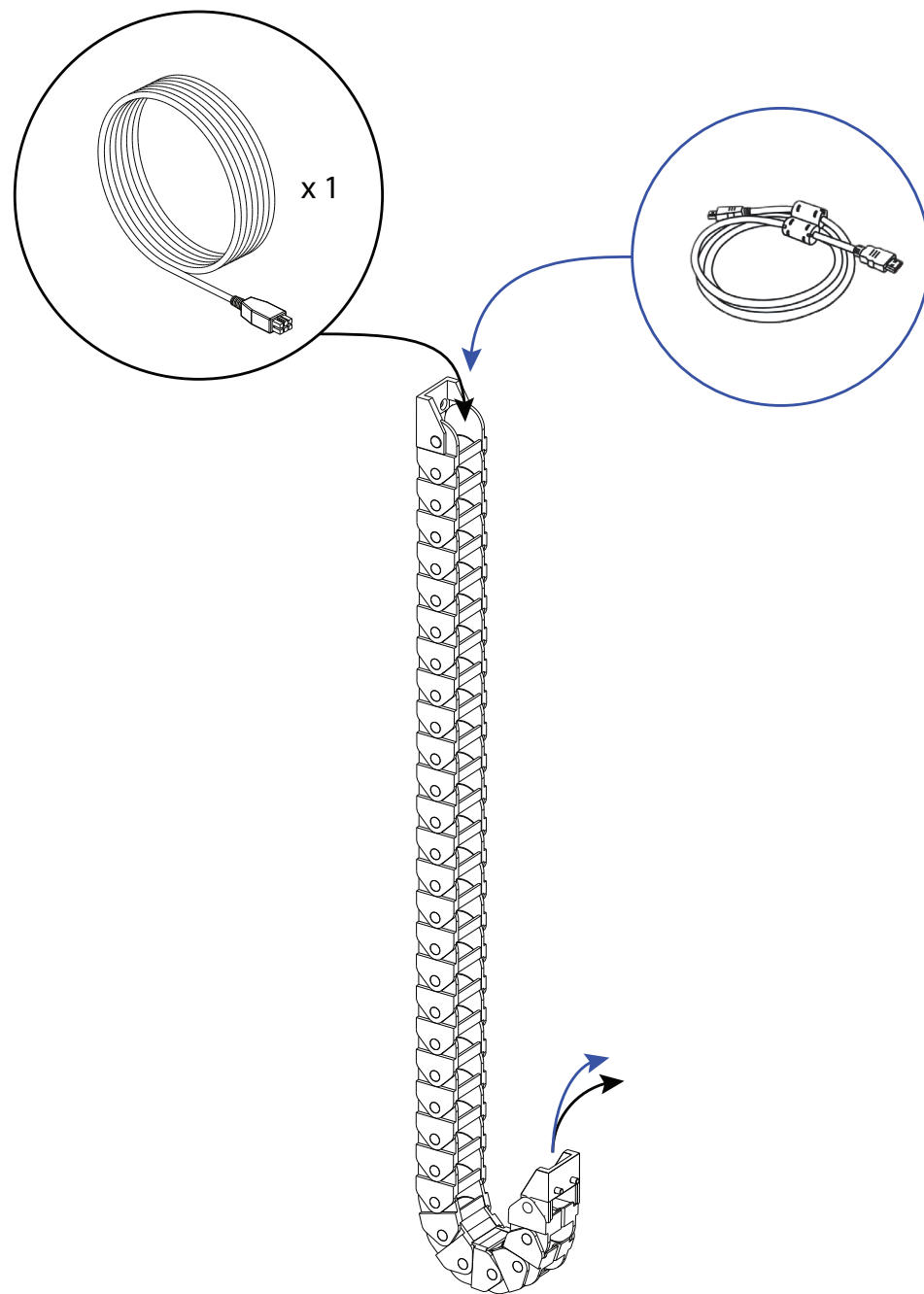
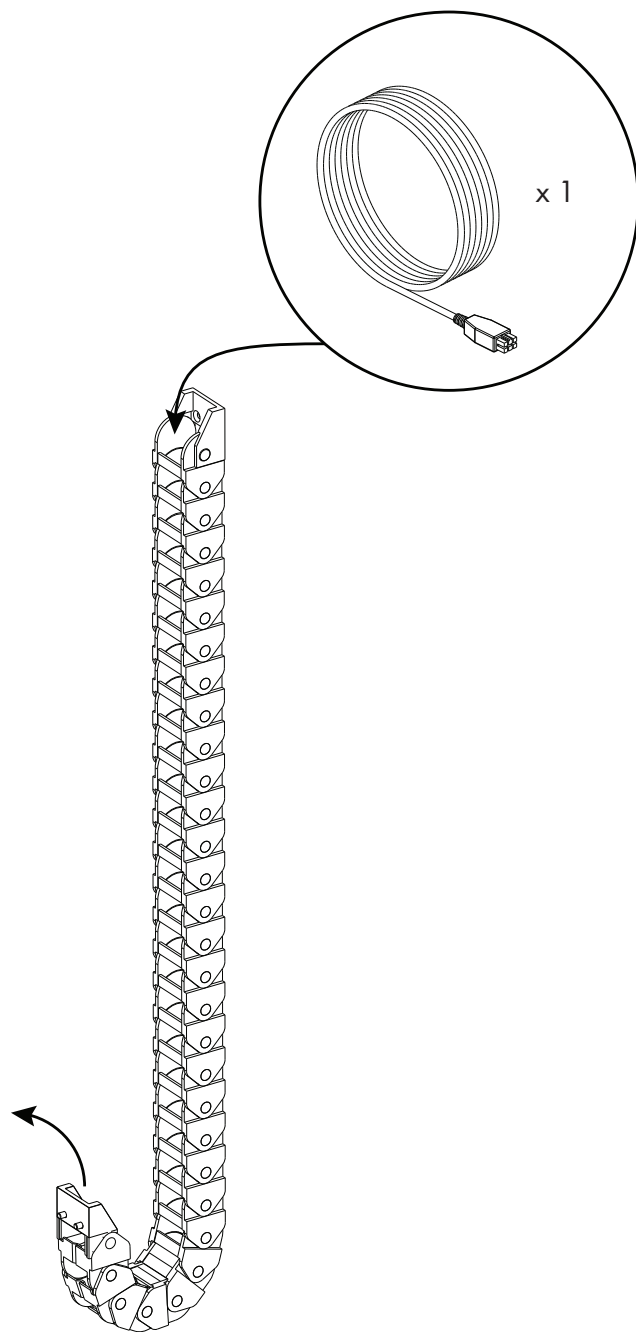

7a. Feed (1) 4.5m Motor Cable through one of the Lower Cable Tracks and label this cable “#1”.

7b. Feed (1) 4.5m Motor Cable through the other Lower Cable Track, label this cable “#2”, then feed any necessary AV Cables through the track.

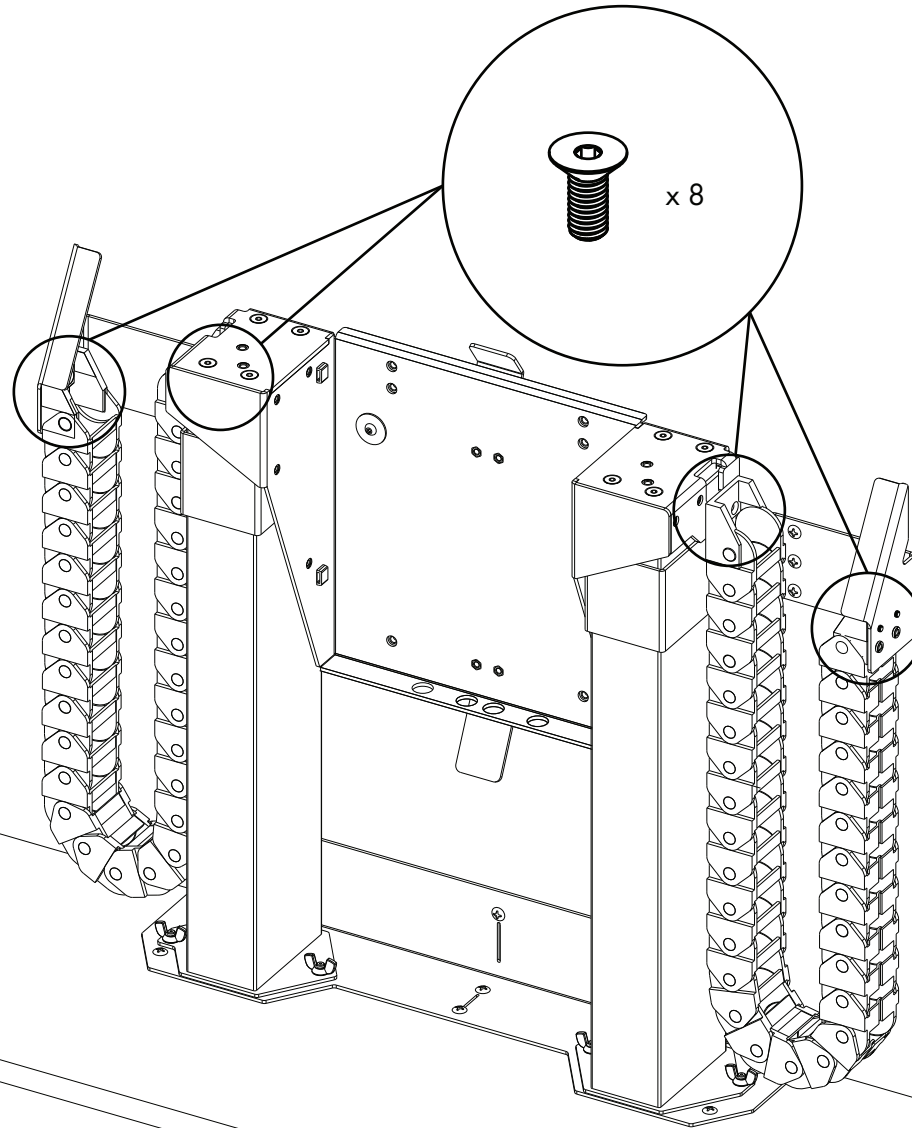
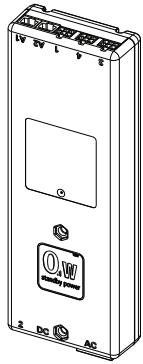

8a. Attach one end of the Lower Cable Track with Cable #2 to the **AV Side** of the Center Riser and Rear Support, using (4) M5 x 12 FHMS.

8b. Repeat this step for the other Lower Cable Track on the **CB Side**.

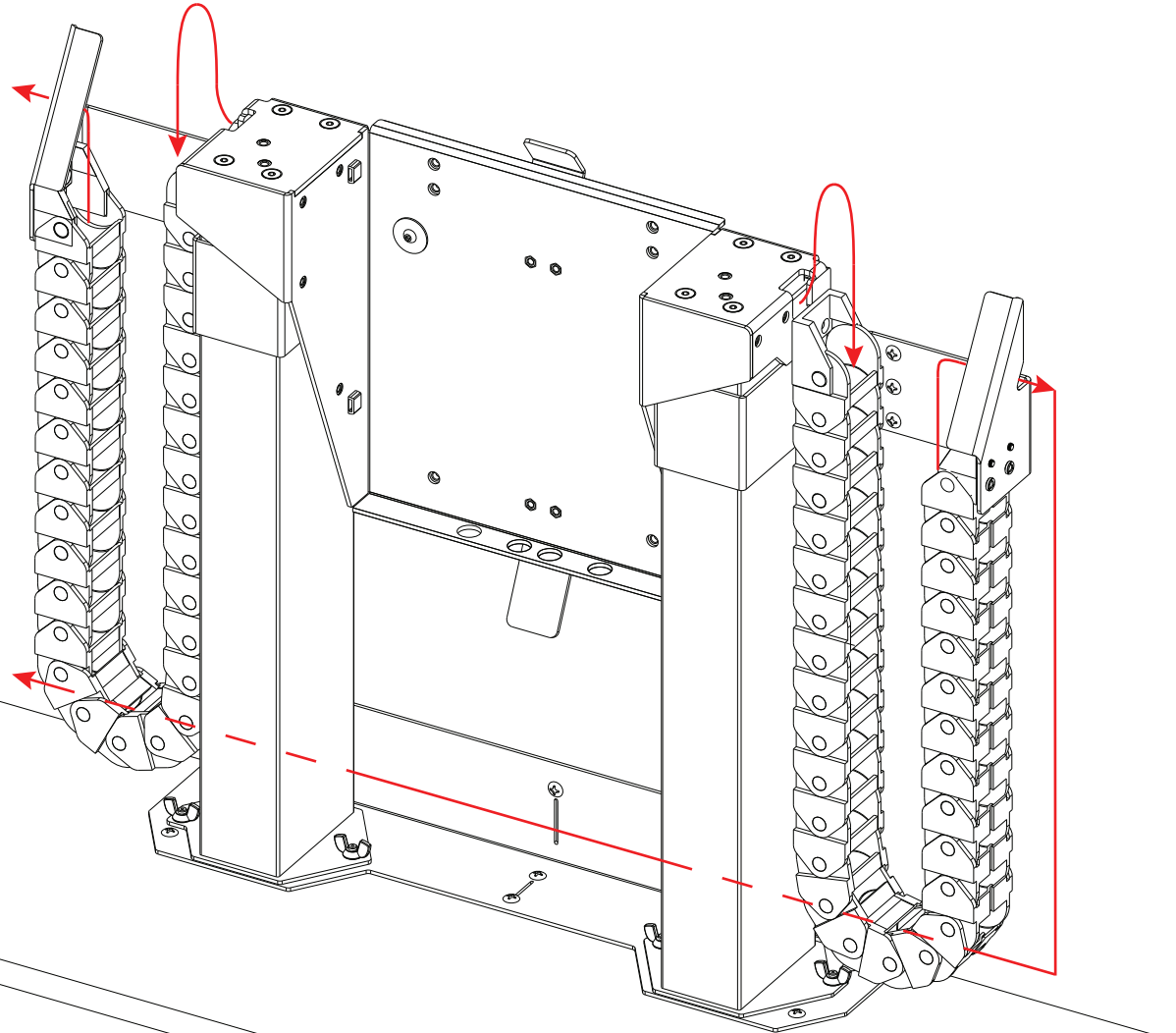
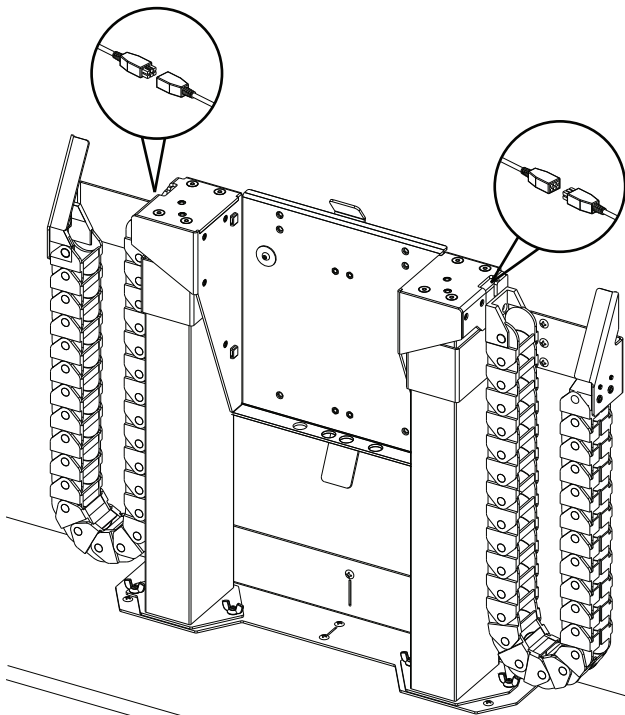

- 9a.** Connect Cable #1 to the Lower Column Pigtail on the **CB Side** and Cable #2 to the Lower Column Pigtail on the **AV Side**.
- 9b.** Pull any slack on these cables down through their respective cable tracks then hang it behind the angled flanges on the Rear Support.
- 9c.** Route Cable #2 behind the Lower Column Assemblies and to the **CB Side** so you can connect it to your Control Box later.

Upper Actuation System

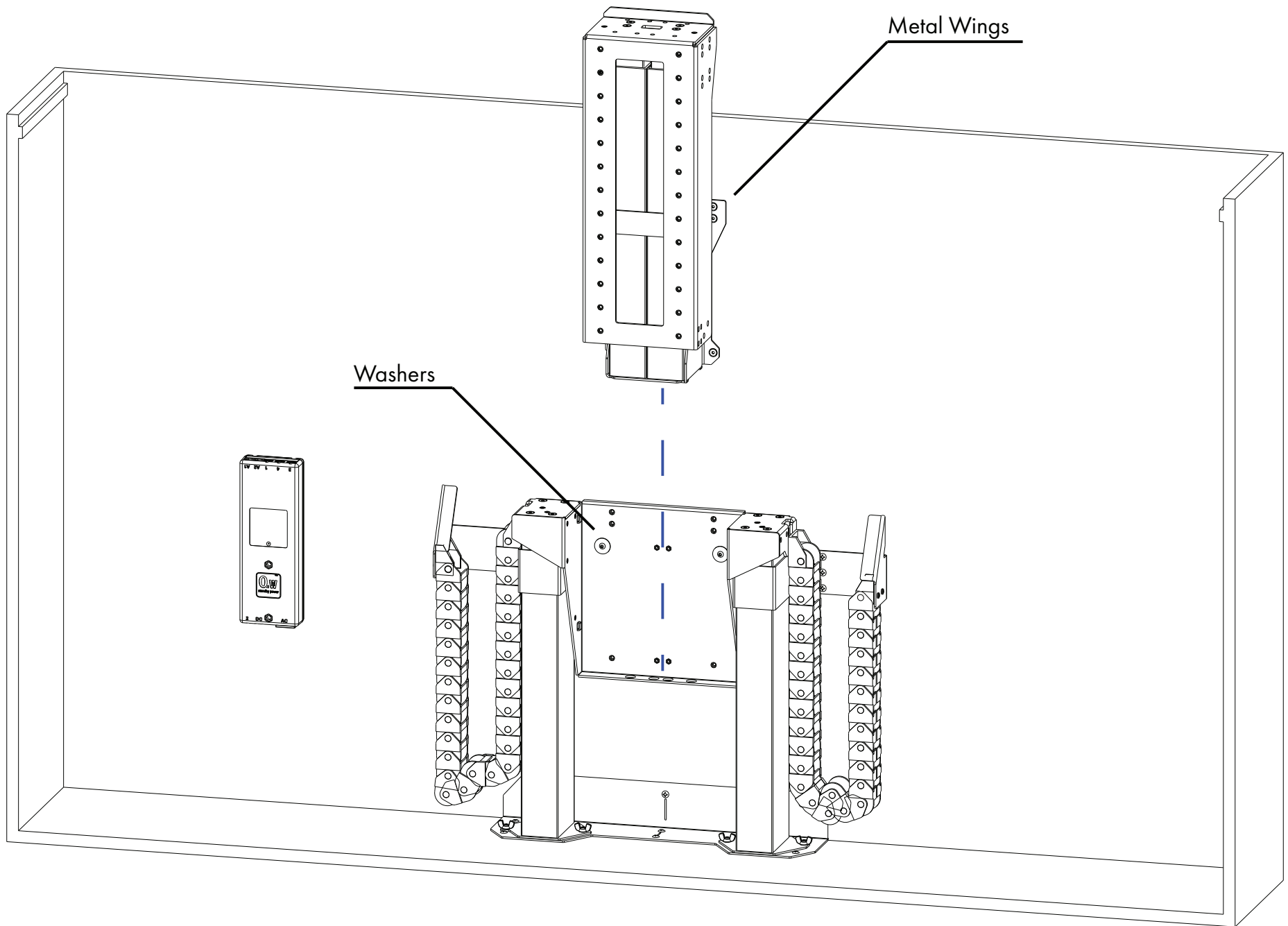

10. Hang the Upper Column Assembly on the Center Riser as shown in the image above.

Note: The metal wings on the back of the Upper Assembly should sit behind the washers on the Center Riser, allowing you let go of the Upper Assembly without it falling.

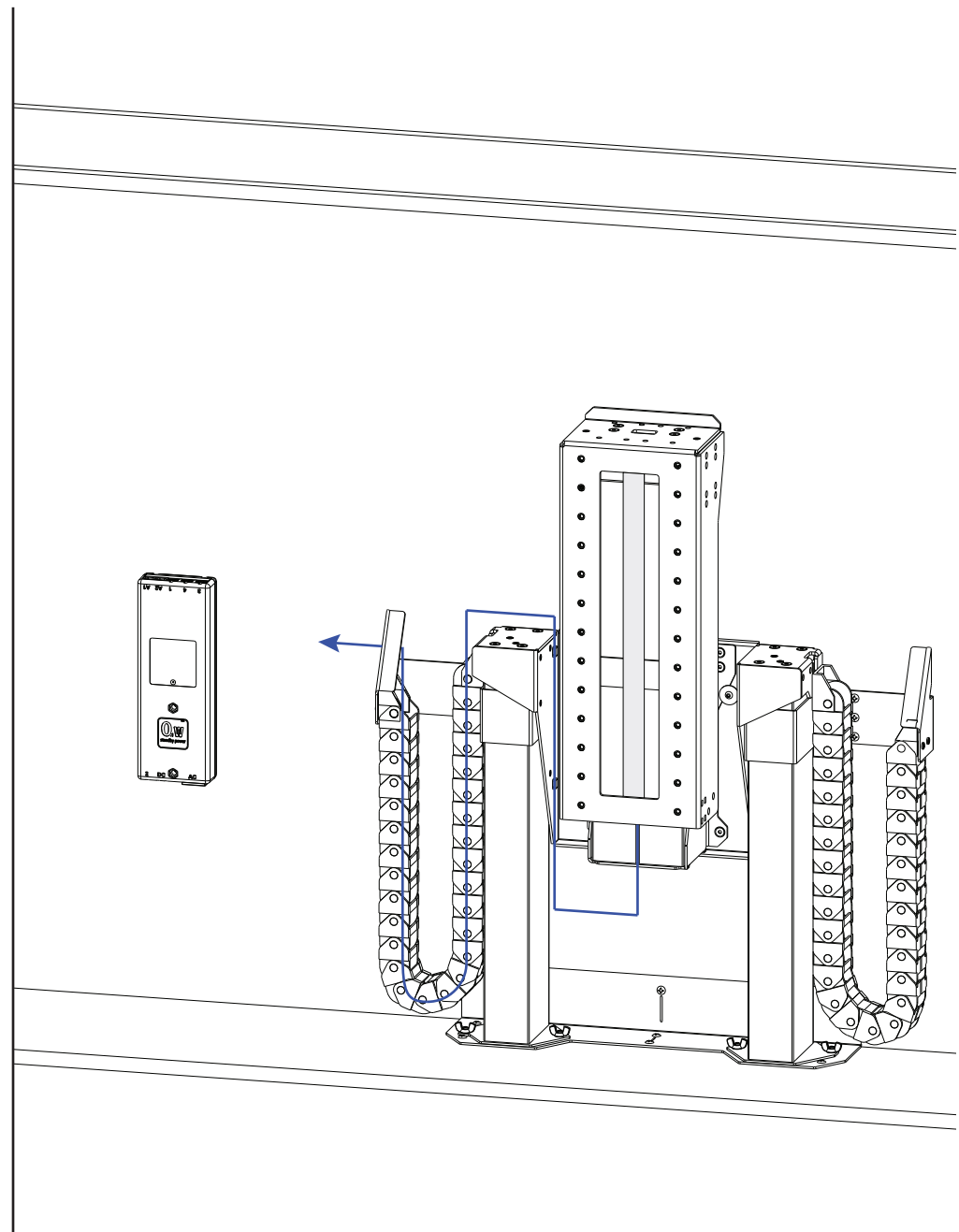
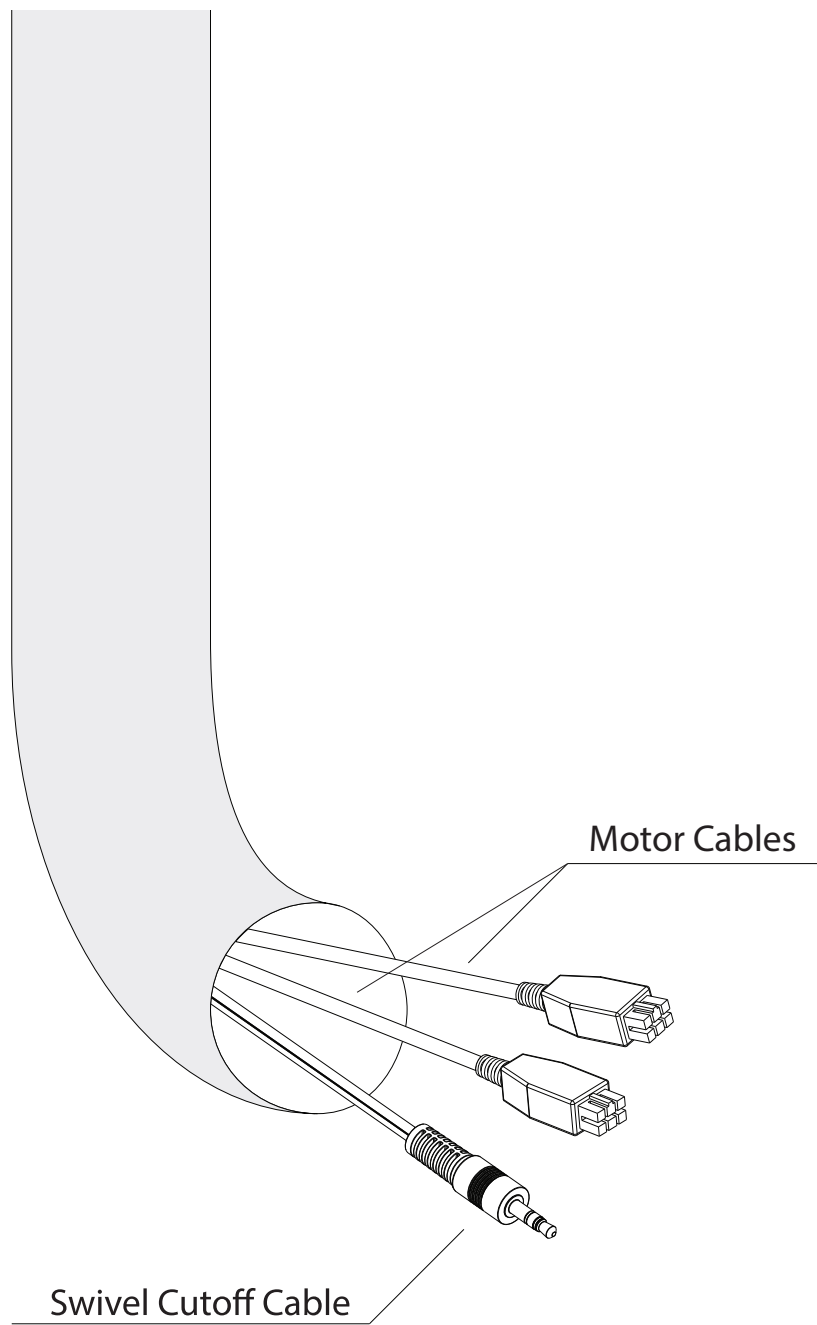

11a. Label the (2) Motor Cables coming off the Upper Assembly “#3” and “#4”; The stereo jack cable is called the Swivel Cutoff Cable.

11b. Feed Cable #3 and #4 down through the Lower Cable Track on the **CB Side** leaving plenty of slack to allow for extension.

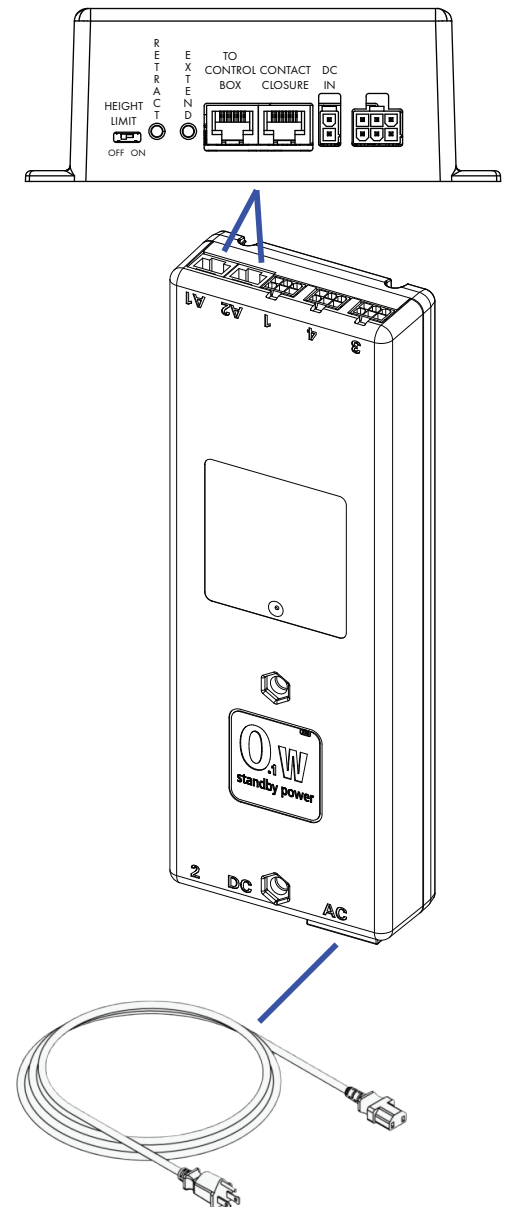
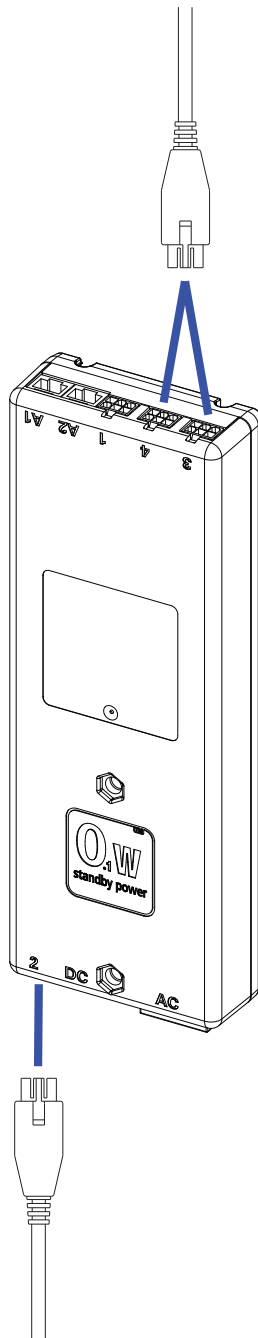
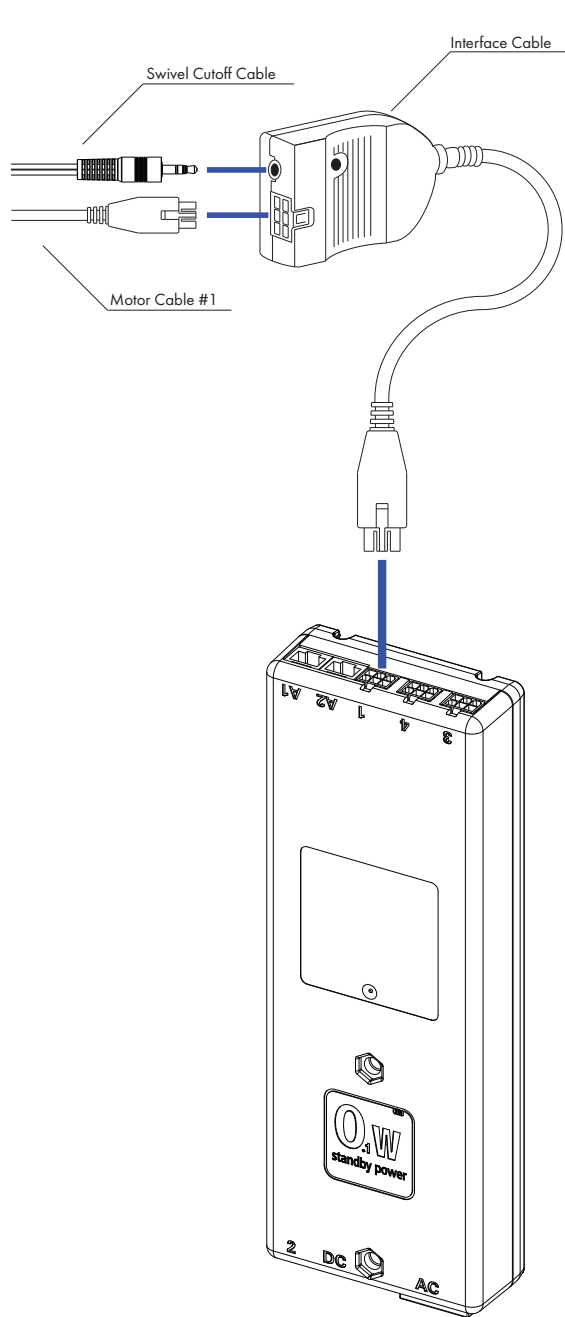

12a. Connect the Interface Cable to Port 1 on the Control Box, then connect the Swivel Cutoff Cable and Cable #1 to the Interface Cable.

12b. Connect the remaining (3) cables to their corresponding ports on the Control Box. Cable #2 to Port 2, Cable #3 to Port 3, Cable #4 to Port 4.

12c. Connect the Power Cord to the AC Port and the Universal Control Hub to Port A1 or A2.

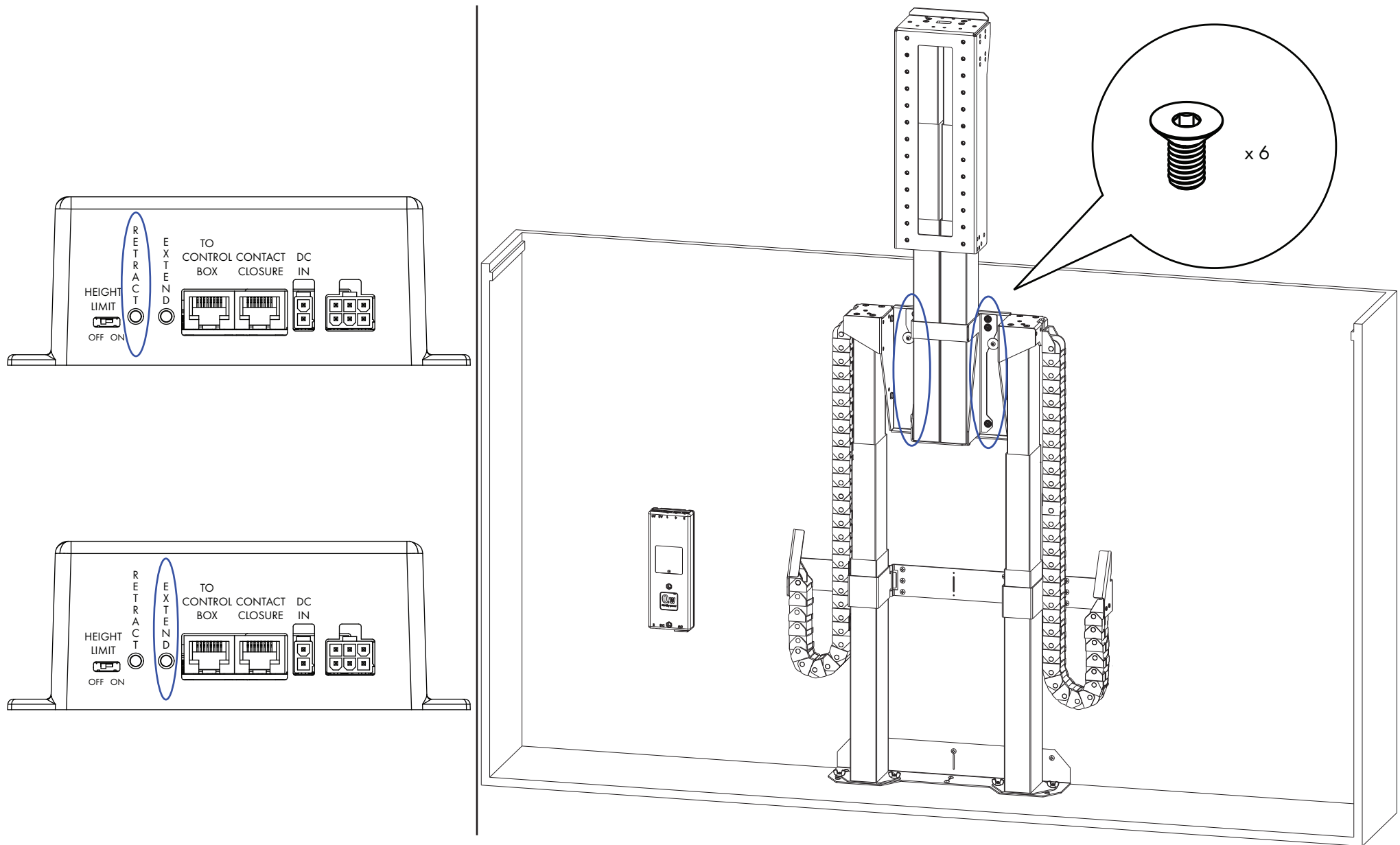

13a. Tap the Retract button on the Universal Control Hub, release, then press and hold it for 5 seconds to perform an 'Initialize'. During this time, you should observe a slight movement from your system indicating it has successfully been initialized. If you do not observe this movement, repeat this step.

13b. Press the Extend button on the Universal Control Hub and raise the system until the bottom of the Screen Support is just above the top of your cabinet, then tap the Retract button to stop it at this position.

13c. Fasten the Upper Column Assembly to the Center Riser using (6) M6 x 12 FHMS.

Upper Cable Management

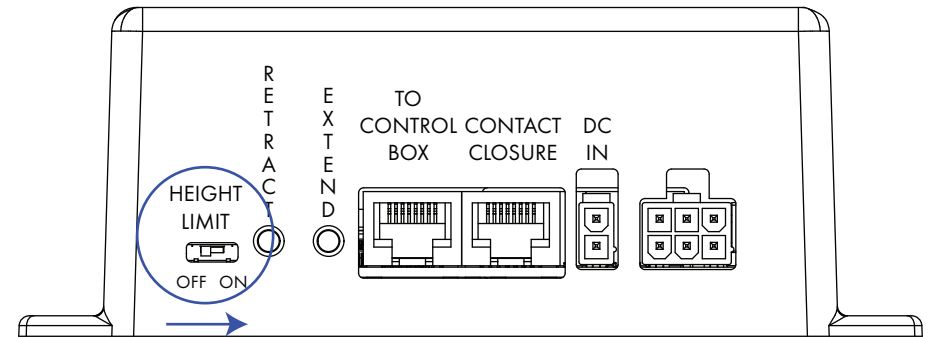
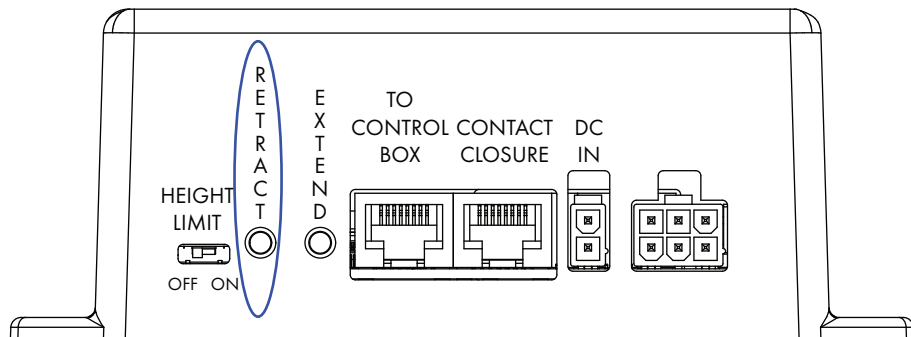
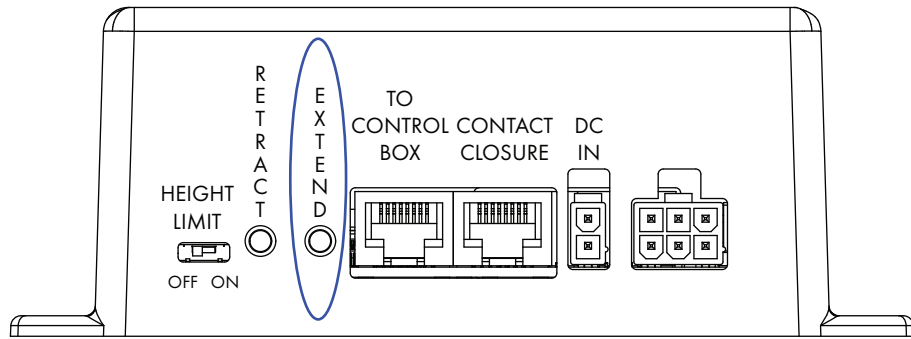

14a. Press the Extend button on the Universal Control Hub to extend the system further, then press Retract to stop it at your desired height.

14b. Slide the Height Limit Switch to ON to limit the extension to the current position of the system.

Note: Setting a Height Limit is not required if you are using the full travel of the system.

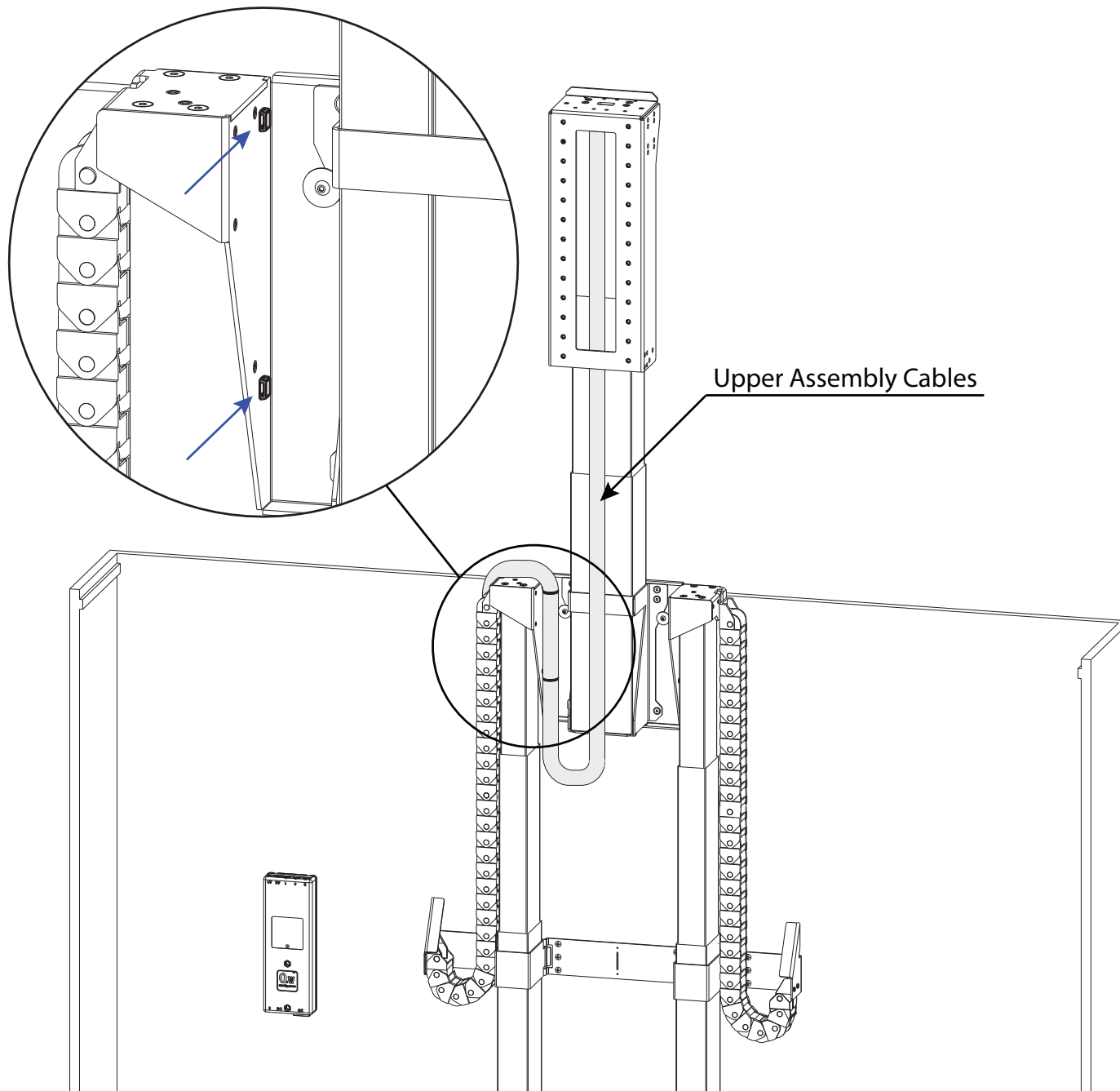

15a. Place (2) Zip Ties in the Zip Tie Anchors on the **CB Side** of the Center Riser.

15b. Loosely secure the Upper Assembly Cables to the Center Riser.

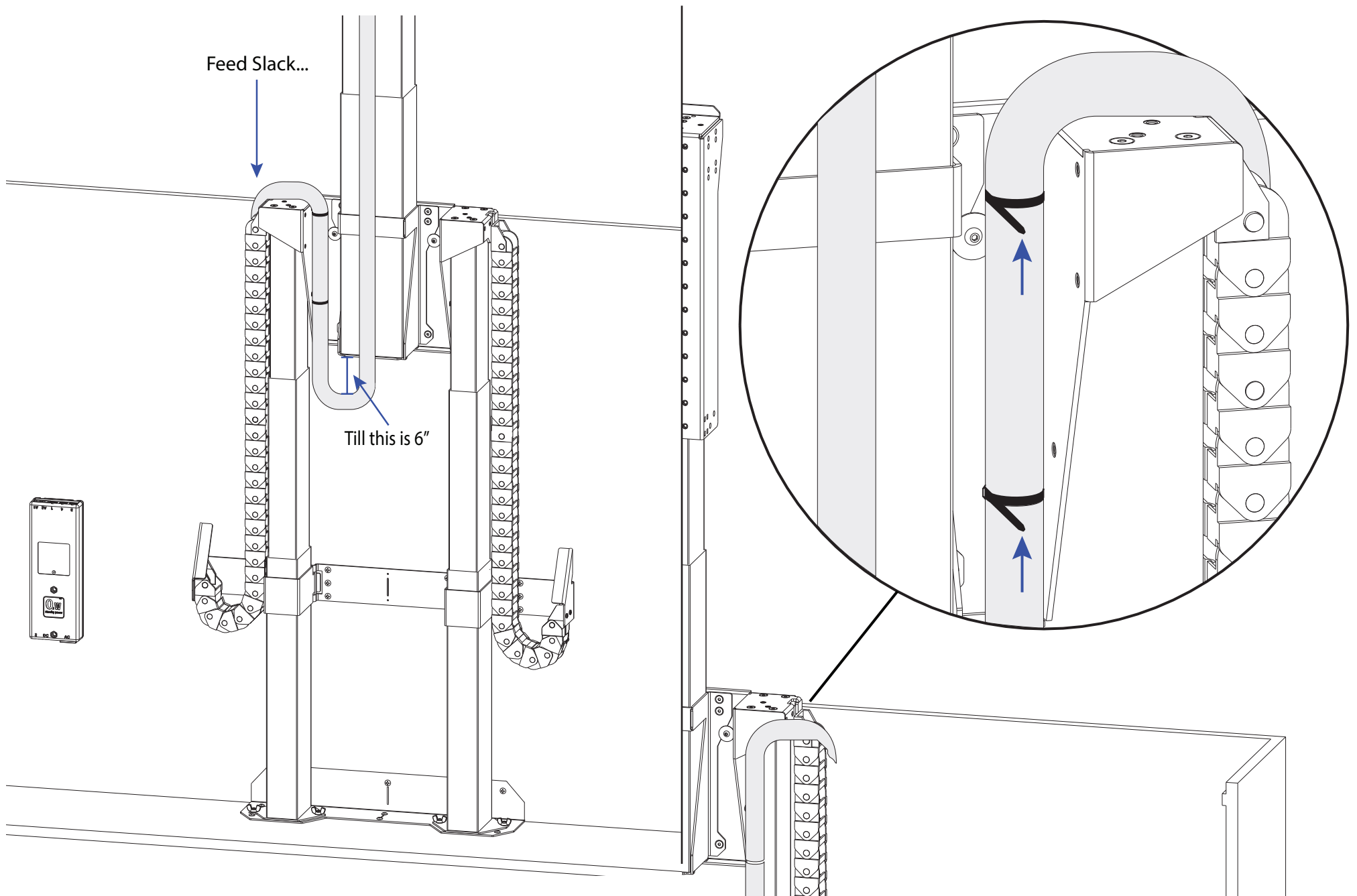

16a. Feed the slack on the Upper Assembly Cables down through the Lower Cable Track on the **CB Side** until the bundle rests ~6" below the Upper Assembly.

16b. Cinch the loose Zip Ties on the Center Riser to secure Upper Assembly Cables in place.

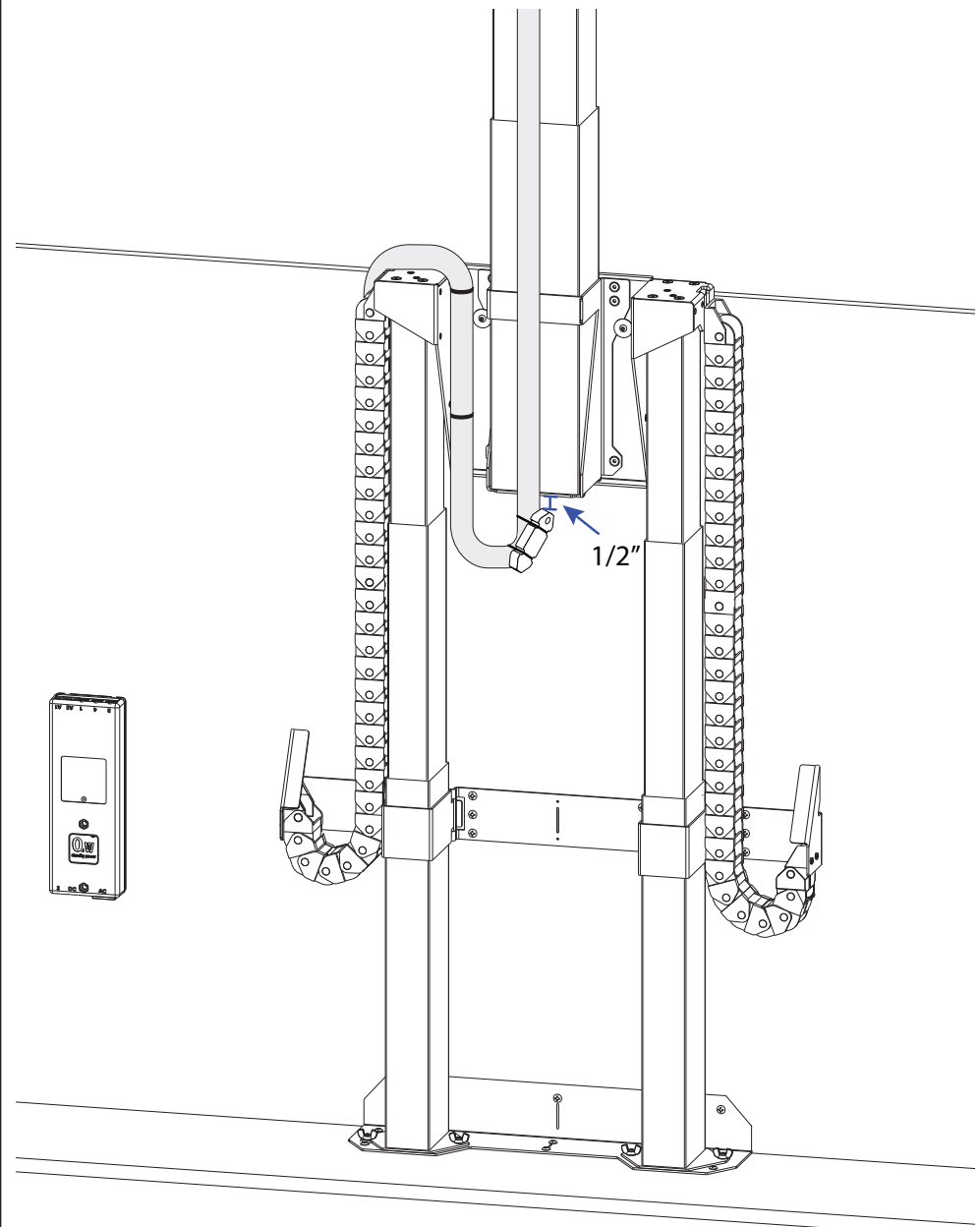
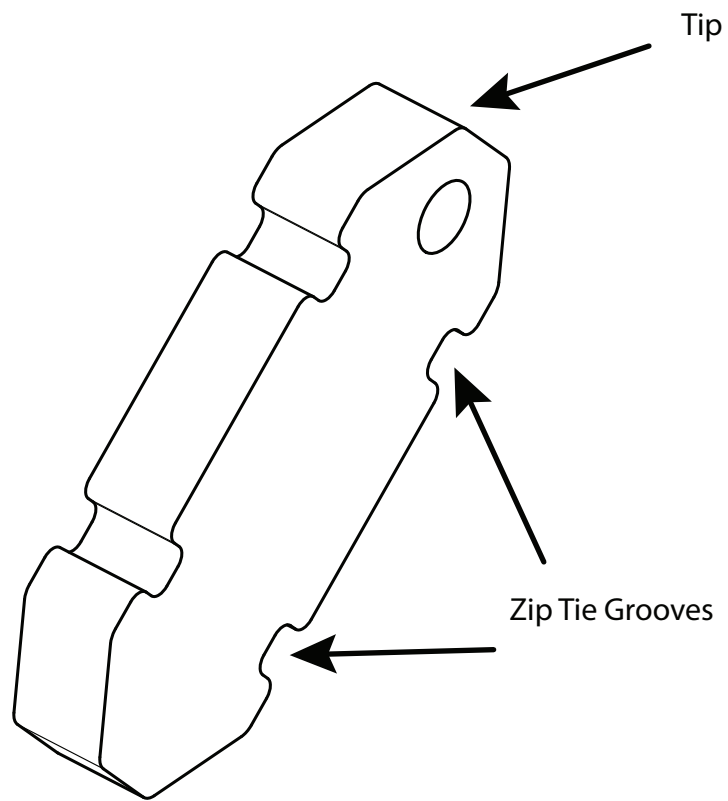

17a. Pull the Upper Assembly Cables taut and make a mark $\sim 1/2"$ below the Upper Column Assembly on them.

17b. Align the tip of the Cable Weight with the mark on the Upper Assembly Cables and secure it to the cables using (2) Zip Ties.

Important Note: Changing the Height Limit from this point forward will require repositioning of the Cable Weight.

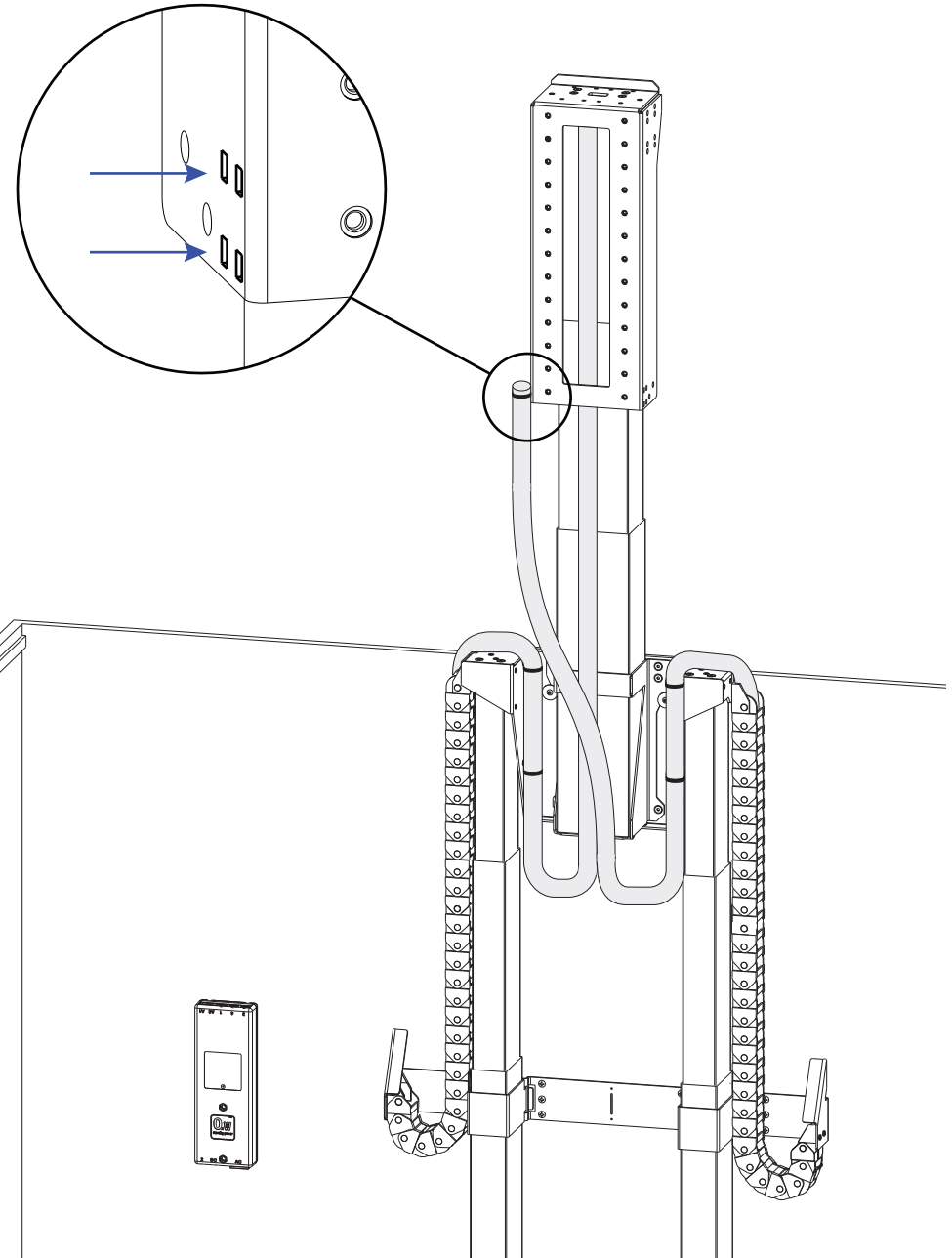
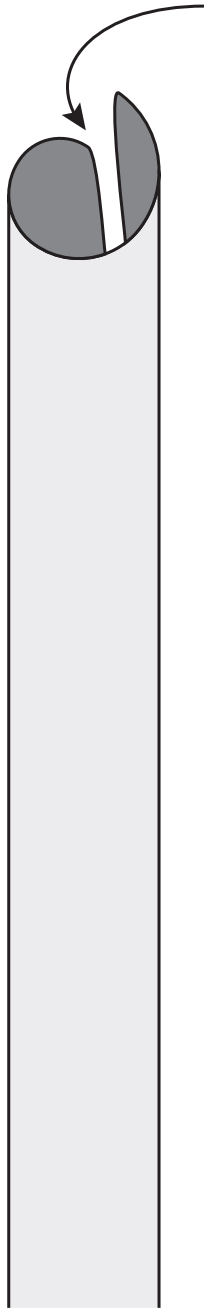

18a. Collect your AV Cables and wrap them with the provided Snakeskin.

18b. Zip Tie the Snakeskin to the Zip Tie Anchors located on the **CB Side** of the Screen Support.

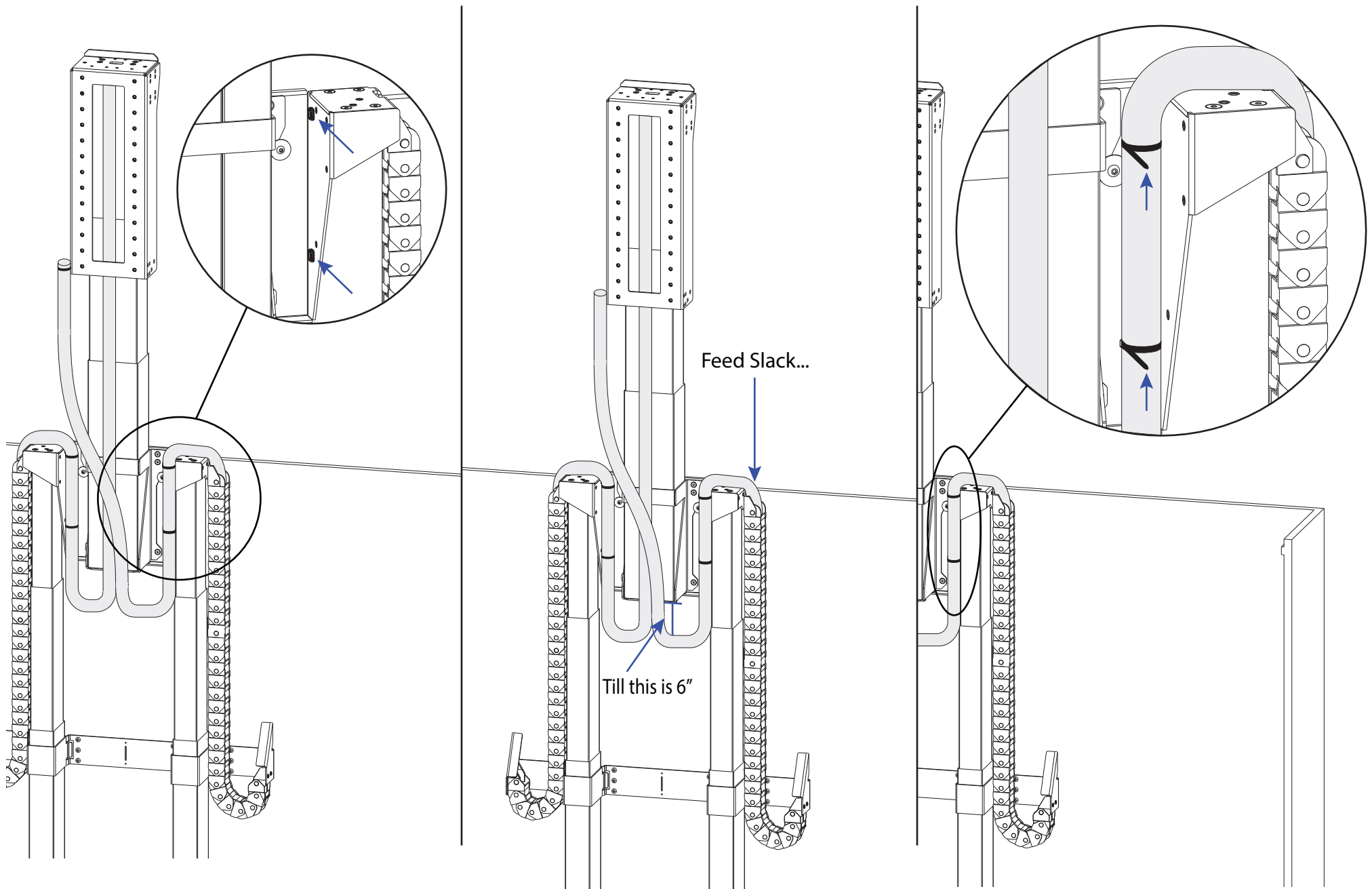

19a. Loosely secure the Snakeskin to the Zip Tie Anchors on the **AV Side** of the Center Riser.

19b. Feed the slack on the Snakeskin down through the Lower Cable Track on the **AV Side** until the bundle rests ~6" below the Upper Assembly.

19c. Cinch the loose zip ties on the Center Riser to secure the Snakeskin in place.

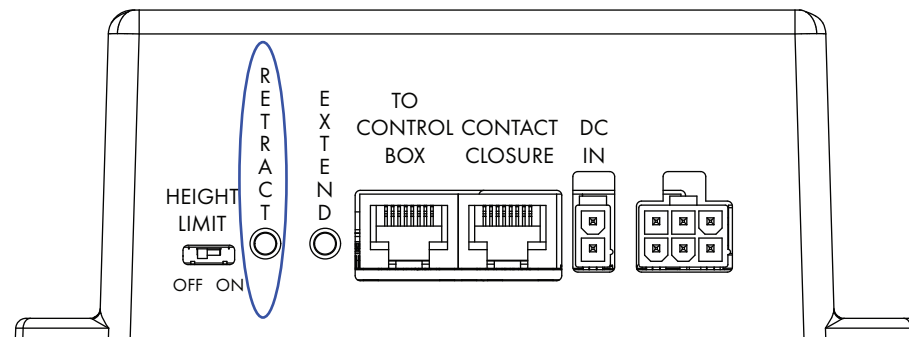
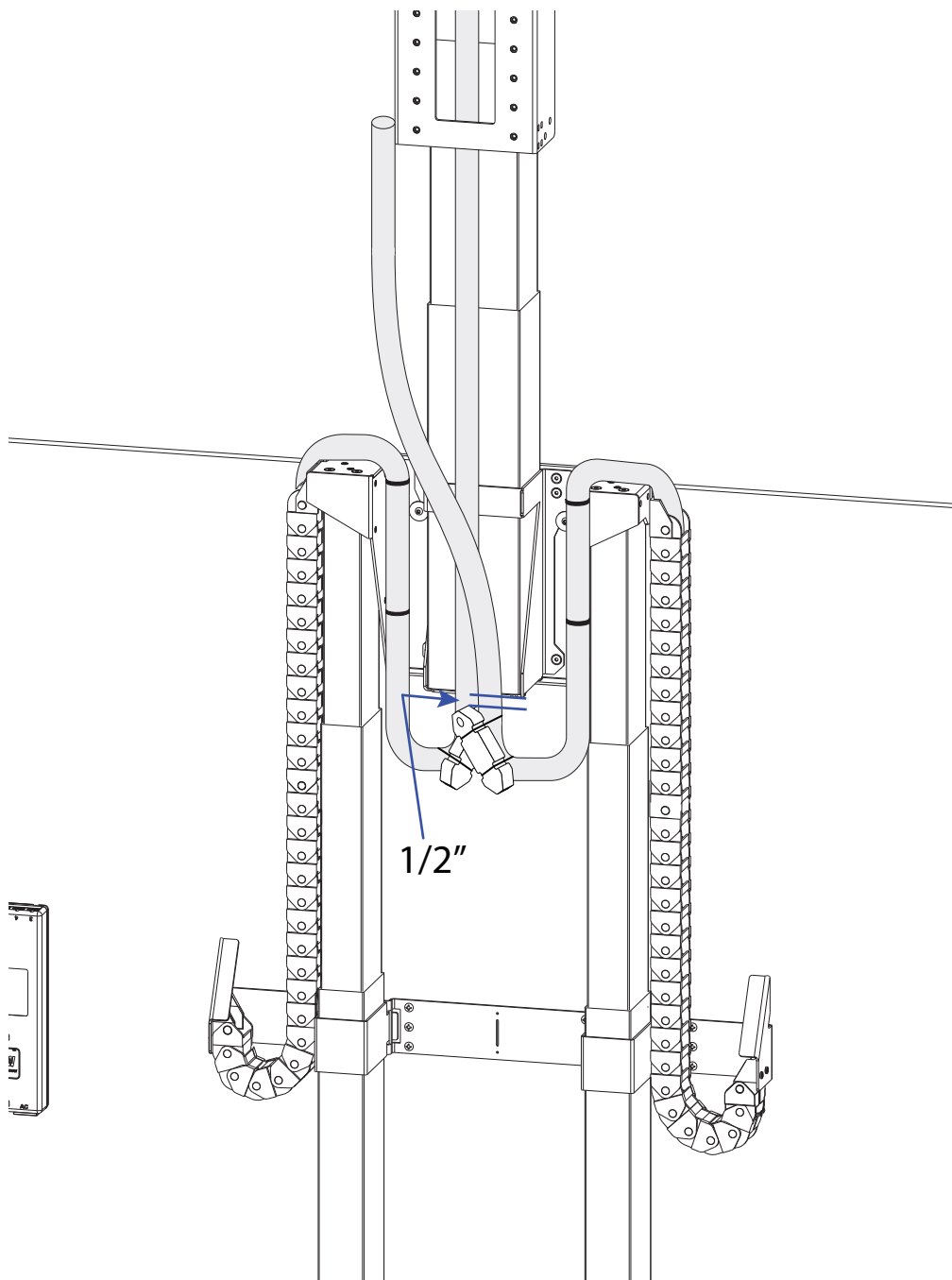

20a. Pull the Upper Assembly Cables taut and make a mark $\sim 1/2''$ below the Upper Column Assembly on them.

20b. Align the tip of the Cable Weight with the mark on the Upper Assembly Cables and secure it to the cables using (2) Zip Ties.

20c. Run your system up and down to ensure there are no issues with the cable management then leave it in the fully retracted position.

Hinged Lid Setup

This system has been tested to run within the following specifications:

Min Screen Size = 65"

Max Screen Size = 86"

Max Weight Capacity = 175 lbs (TV + Lid + Soundbar)

Failure to install your application within these specifications will void your warranty.

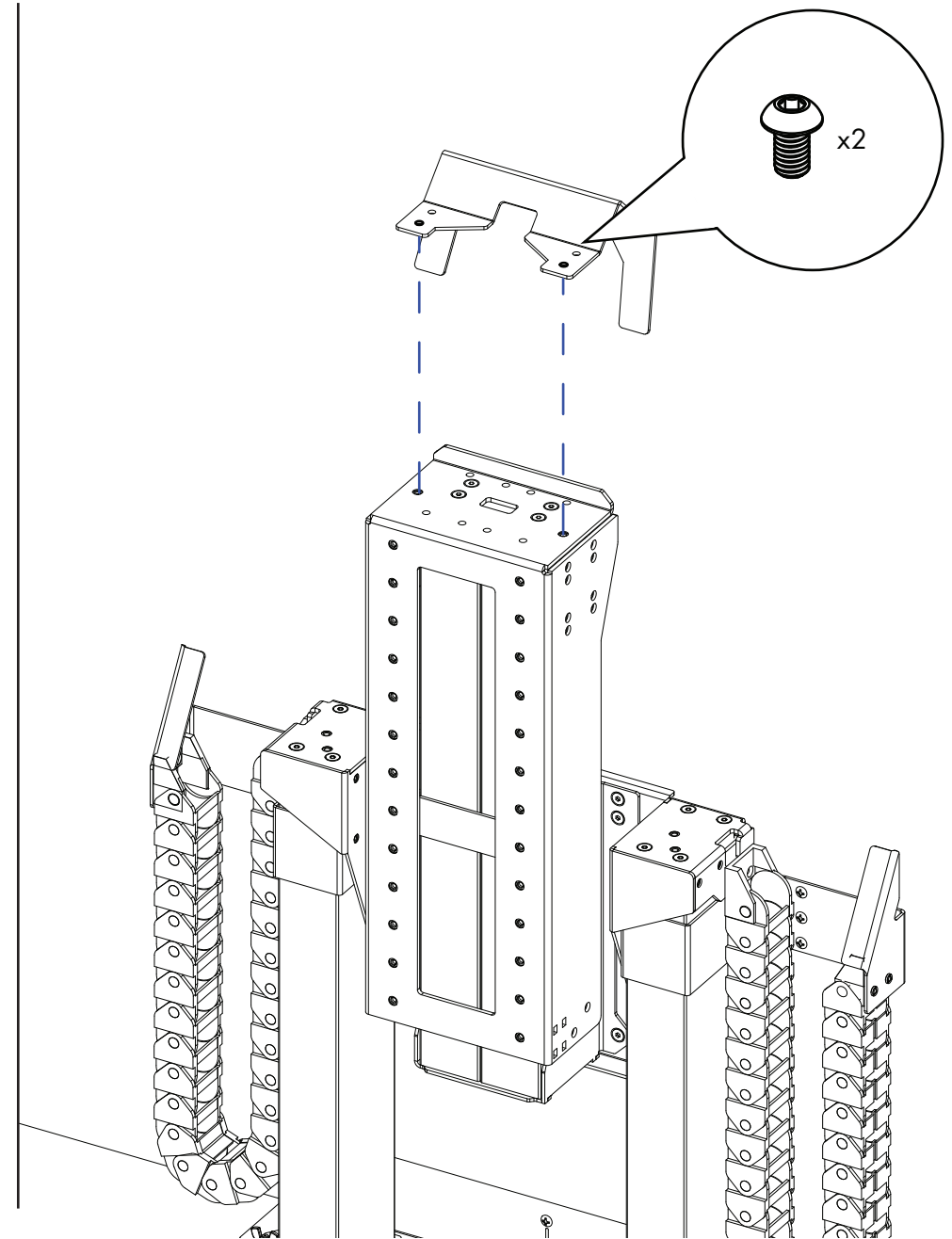
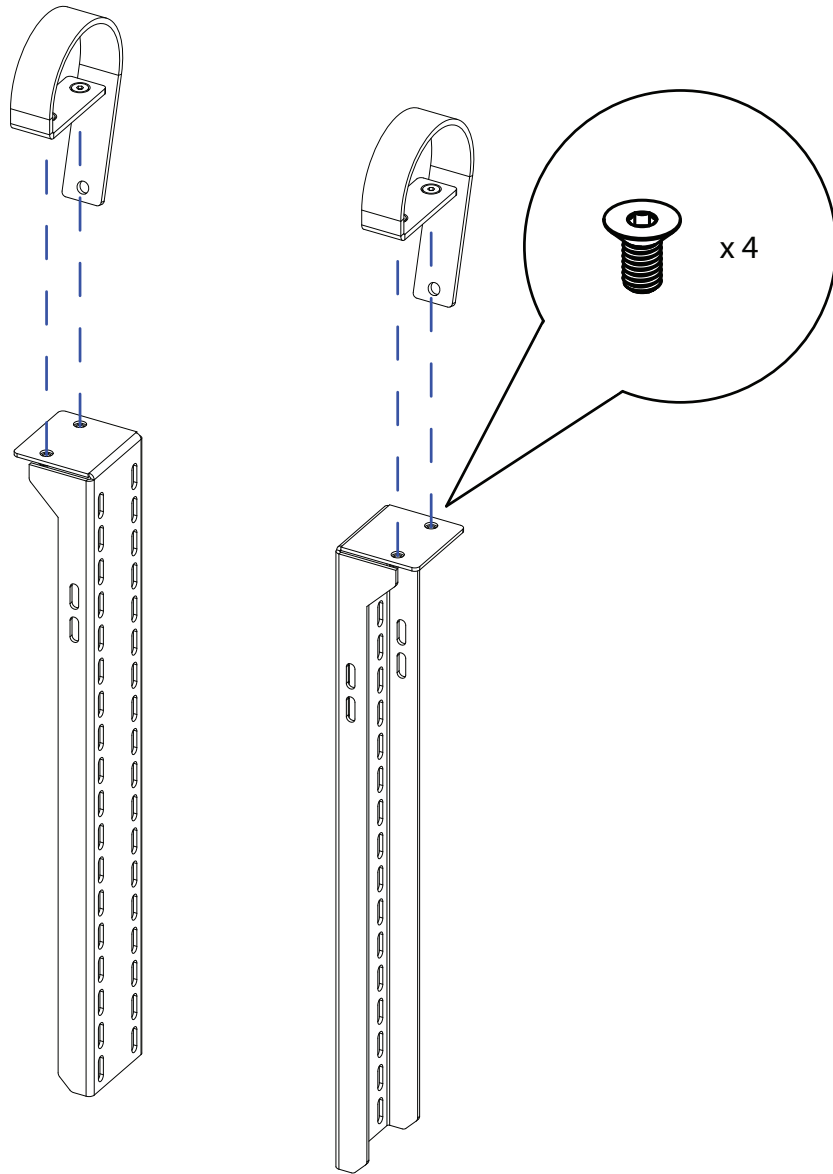

21a. Attach the Curved Hinged Top Guide Brackets to the top of each Lid Support using (4) M6 x 12 FHMS.

21b. Attach the Large Hinged Top Guide Brackets to the top of the Screen Support using (2) M6 x 10 BHMS.

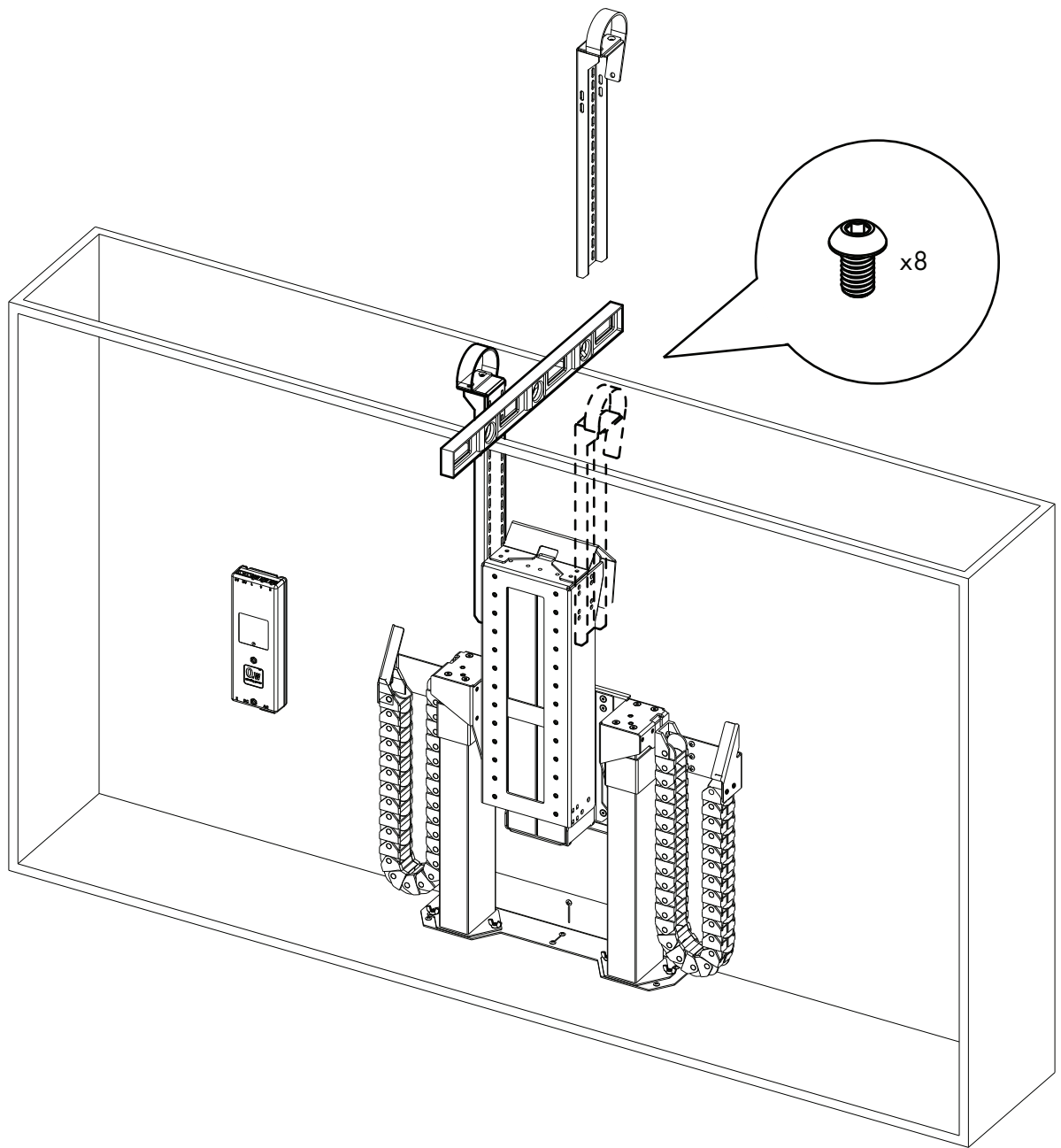
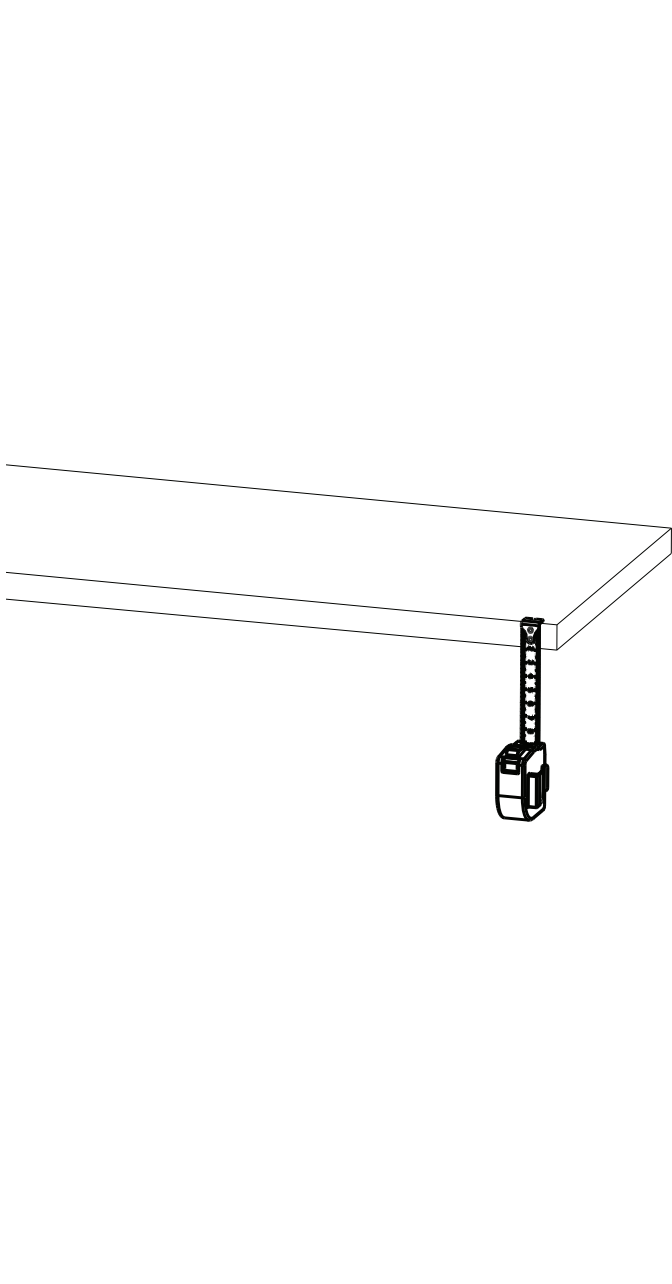

22a. Measure the thickness of your lid and add 1/4" to it. Write that measurement here: _____

22b. Place a level or straight edge across the top of your opening. The bottom of the level or straight edge will be used to locate your Hinge Top Guides.

22c. Position your Lid Supports along the left and right sides of the Upper Assembly so the tops of the Hinged Top Guides rest a distance equal to the measurement taken in step 22a, below your level or straight edge, then attach them using (4) M6 x 10 BHMS per Lid Support.

Note: If necessary, (2) M6 x 10 BHMS can be used per Lid Support, instead of (4).

TV Mounting

This system has been tested to run within the following specifications:

Min Screen Size = 65"

Max Screen Size = 86"

Max Weight Capacity = 175 lbs (TV + Lid + Soundbar)

Failure to install your application within these specifications will void your warranty.

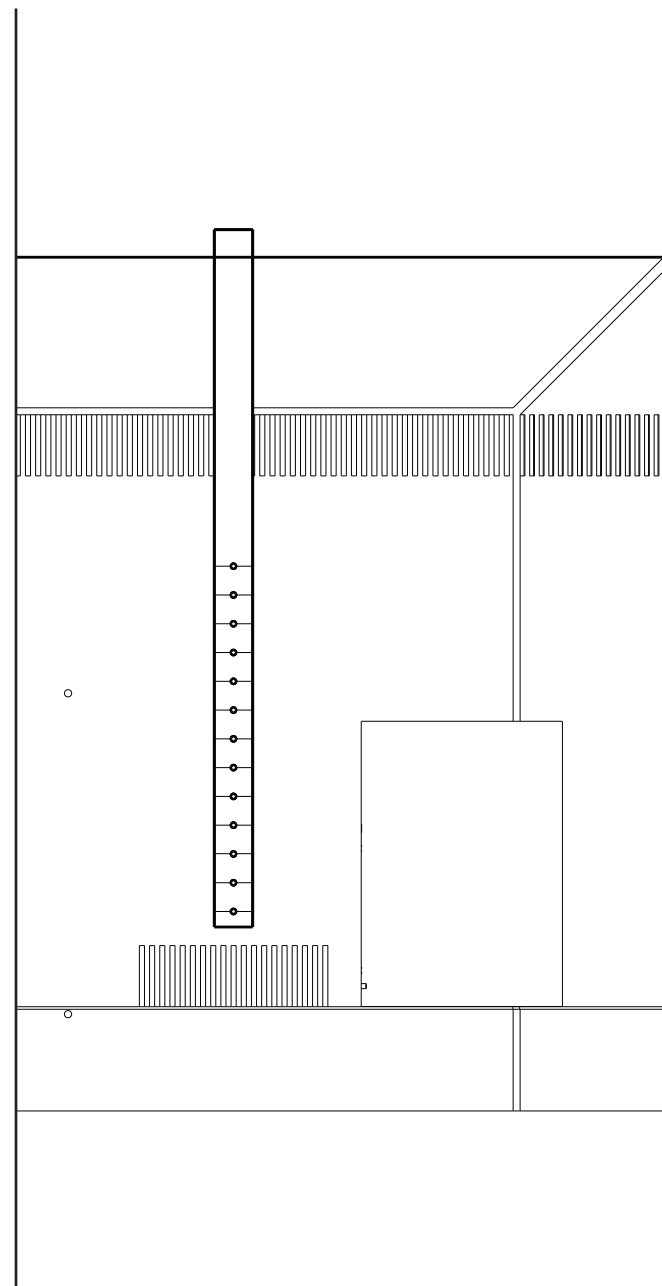
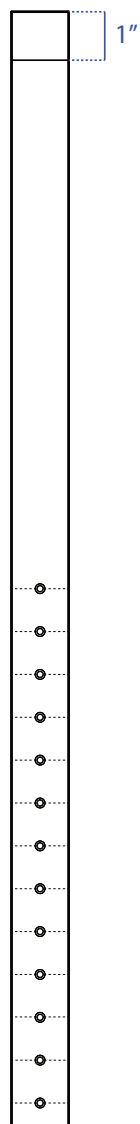
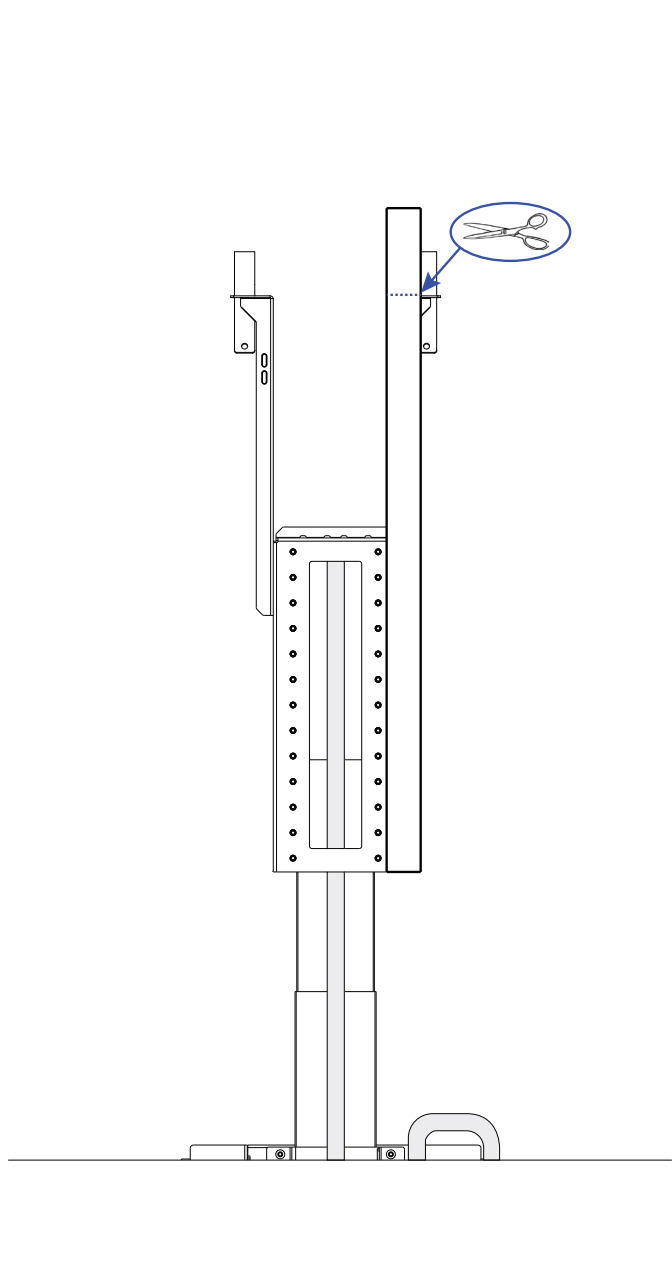

23a. Raise your lift, align the template with Screen Support Holes, then fold or cut the template to be flush with the **bottom** of the Hinged Top Guide.

23b. Measure 1" from the top of the Template and draw a line. This line indicates the position for where the Top of the TV will go.

23c. Align the line you just drew with the top of the TV

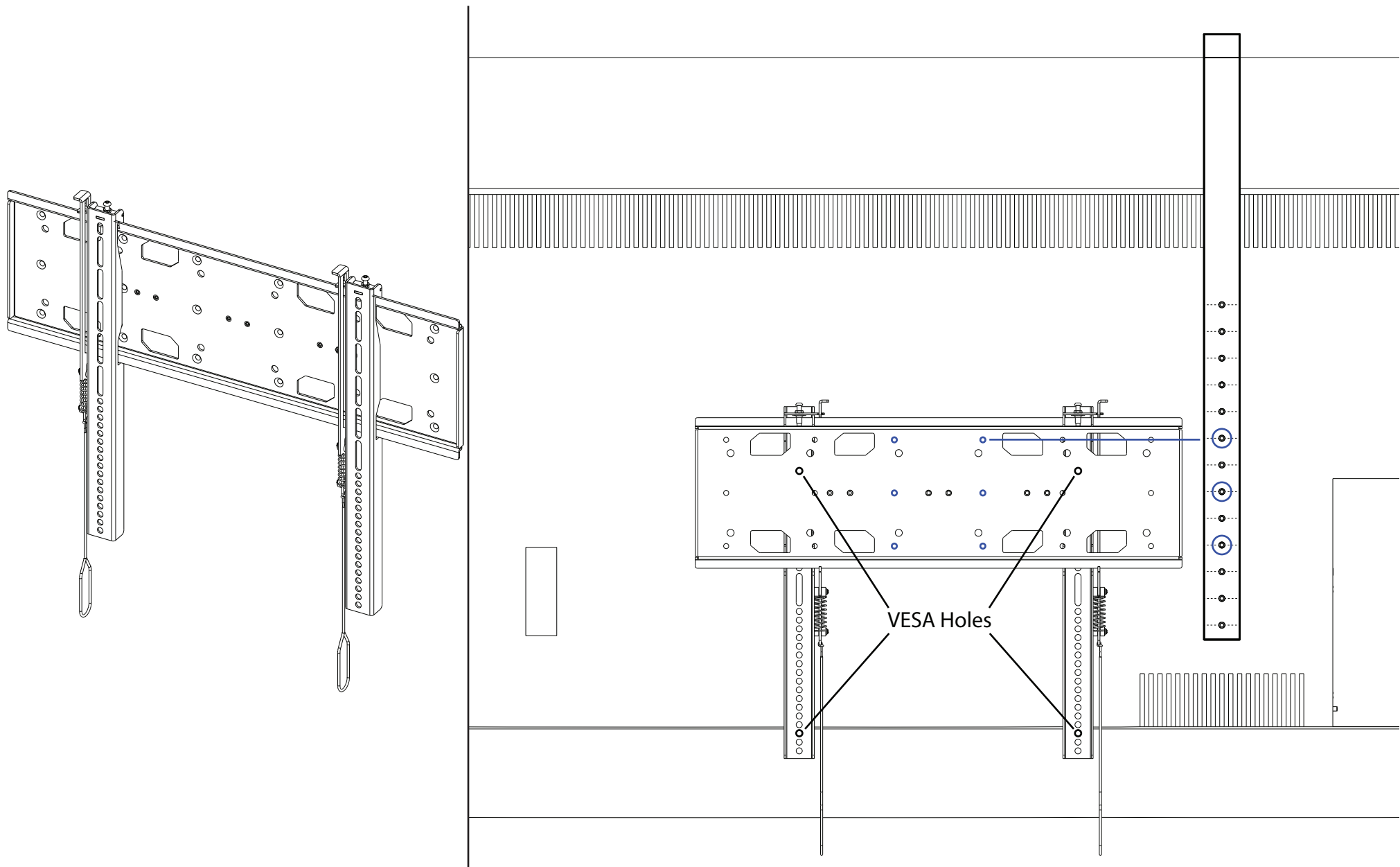

24a. Attach Vertical Bars to Screen Backplate, ensure the spring-loaded latch on each Vertical Bar is engaged with the Screen Back Plate.

24b. Place the Vertical Bars and Screen Backplate on the back of the TV, and position the Vertical Bars over the VESA Holes.

24c. Adjust the vertical position of them both until the (6) smaller holes of the Screen Backplate, line up with the lines on the Template and the Vertical Mounting Bars align with the VESA Holes on your TV.

24d. Mark the holes for the Screen Backplate on the template and the holes for mount your TV on the Vertical Mounting Bars.

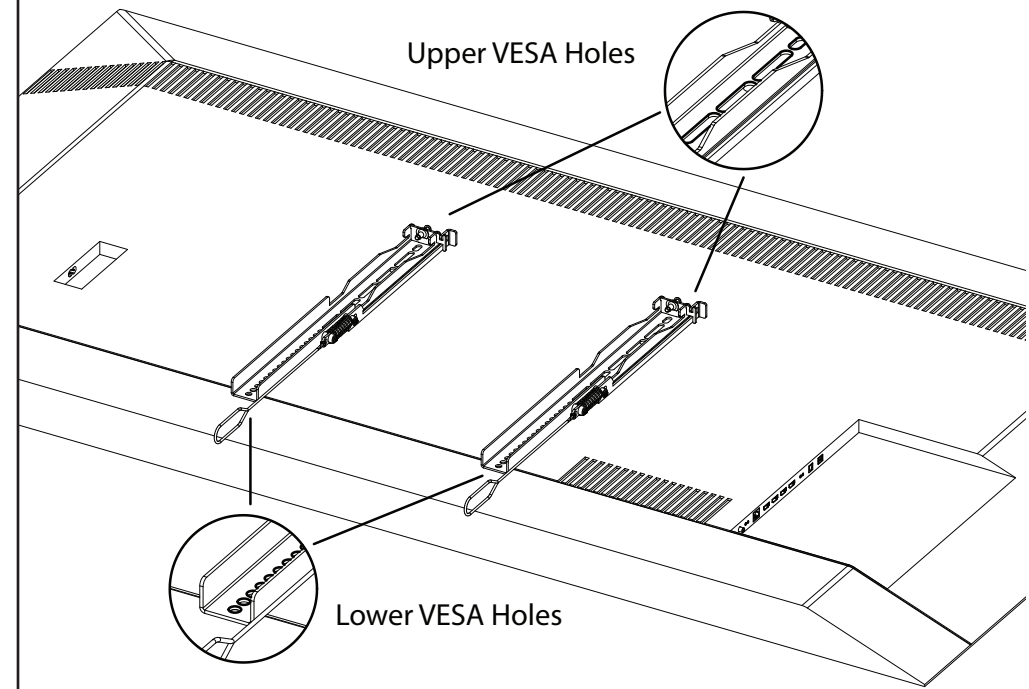
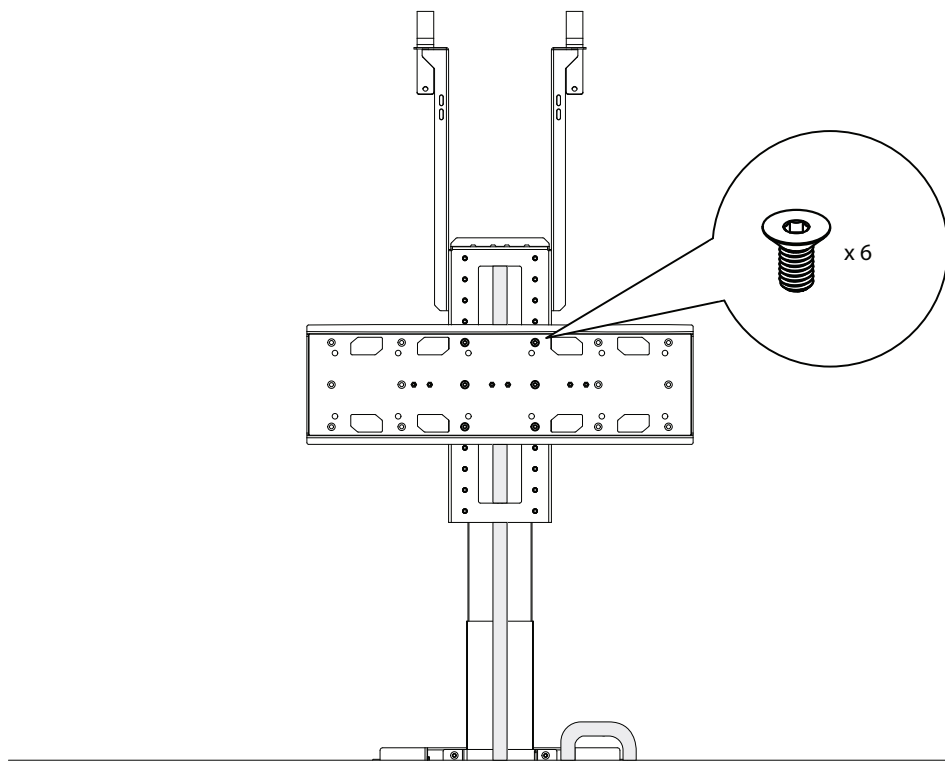

25a. Disconnect the Screen Back Plate from the Vertical Bars and attach it to the holes on the Screen Support that correspond with the marked holes on your Template using (6) M6 x 12 FHMS Screws.

Note: You can disengage the spring-loaded latch on the Vertical Bars by pulling on the straps at the bottom or pushing the tab at the top.

25b. Attach the Vertical Mounting Bars to your TV using the marked holes. If using a Soundbar, follow the informational sheet included with it first.

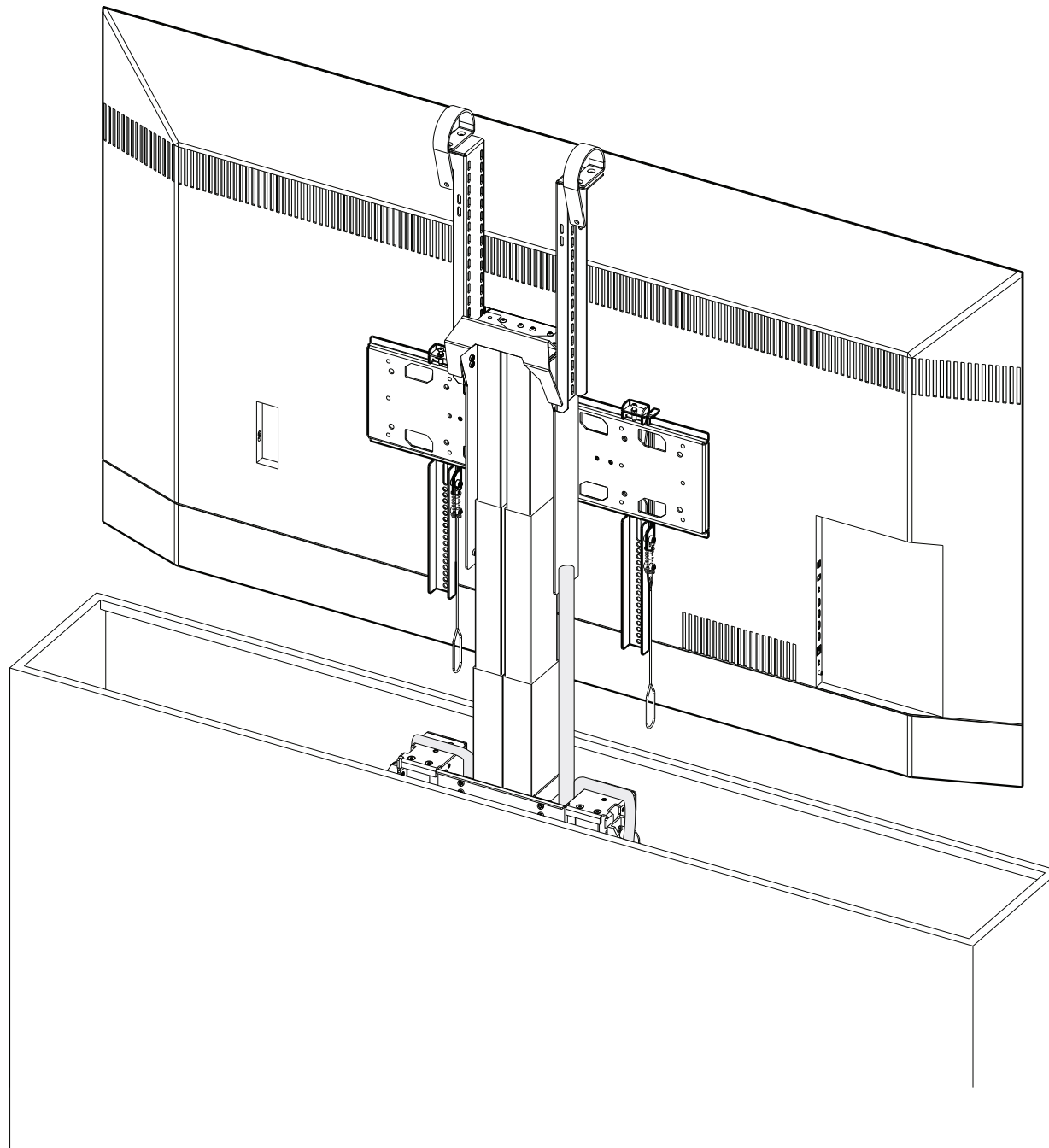

26. Hang your TV on the Screen Backplate, ensure the spring-loaded latch on each Vertical Bar is engaged with the Screen Back Plate.

Intentionally left blank

Intentionally left blank

www.nexus21.com

1 - 888 - 991 - 6166

