



QUICK START GUIDE

GUIDE DE DÉMARRAGE RAPIDE | GUÍA DE INICIO RÁPIDO
KURZANLEITUNG | SNELHANDLEIDING | GUIDA DI AVVIO RAPIDO

Signa S4™

1 Unpack

Check that you have the following items.

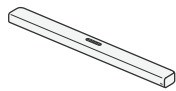

Sound bar



Subwoofer



Quick Start Guide



Safety Instructions

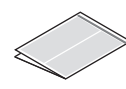

Cautions on Using Batteries

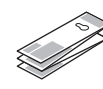

Wall Mounting Template



Wall mount spacers



Sound bar power cable



Subwoofer power cable

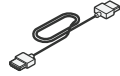

HDMI cable



Optical cable



Remote control



Batteries

2 Connect your TV

If your TV has an HDMI port, you will want to connect the sound bar via HDMI for the best sound performance.

1. Connect one end of the HDMI cable to the TV port labeled "eARC" or "ARC".
2. Connect the other end of the HDMI cable to the HDMI (eARC) port on the back of the sound bar.

NOTE: If your TV does not have an HDMI port, you can connect the sound bar to your TV using the optical cable. However, please note that an optical connection does not support Dolby Atmos.

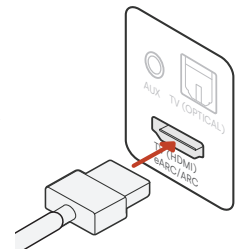

3 Plug in the power cable

Plug the power cable into the sound bar and into a wall outlet.

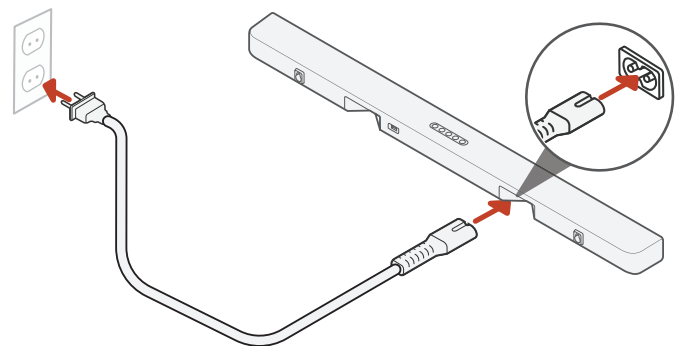

4 Place the sound bar

For the best listening experience, place the sound bar centered in front of your TV and flush with the front edge of your cabinet.

NOTE: If you want to mount the sound bar on the wall, use the included wall mounting template.

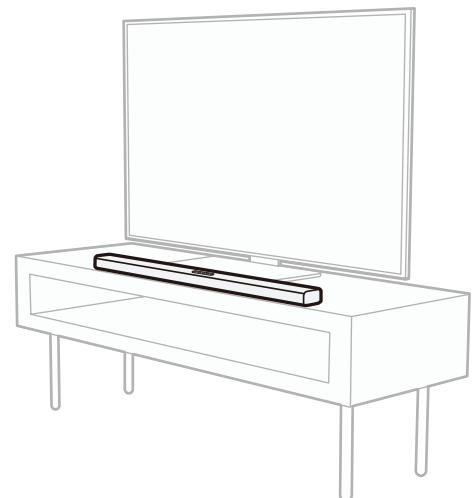

5 Set up the subwoofer

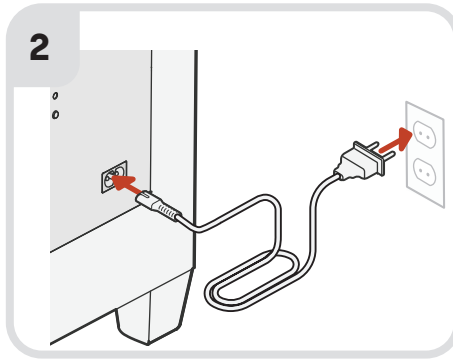
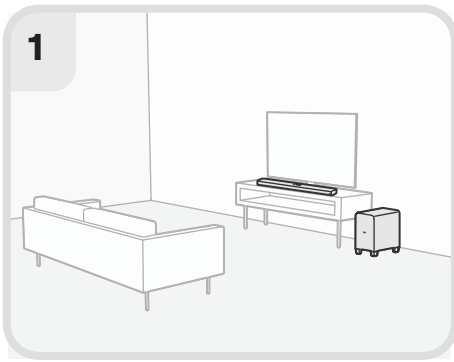

1. For best performance, place the subwoofer on the same wall as the TV, no more than 10m from the sound bar.
2. Plug the power cable into the subwoofer and into a wall outlet.

6 Set up the remote

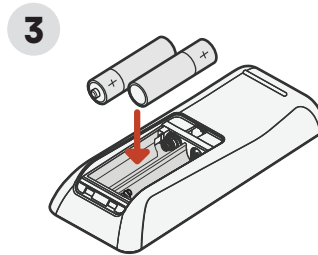
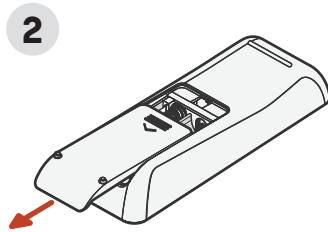
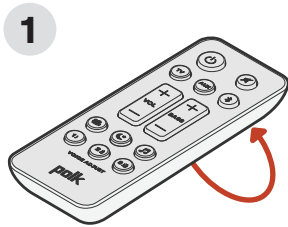

1. Turn the remote to view the back.
2. Open the back cover by sliding the bottom portion in the arrow direction.
3. Insert the two AAA batteries into the remote and replace the cover.

Setup is now complete!

Watch TV or play a movie and adjust the sound bar volume and other settings as desired. You can use the sound bar top panel, the sound bar remote, or your TV remote to change the settings. For more information, refer to the online manual.

polkaudio.com/signas4

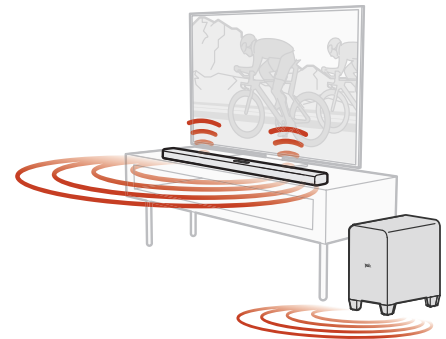

Remote Control Features

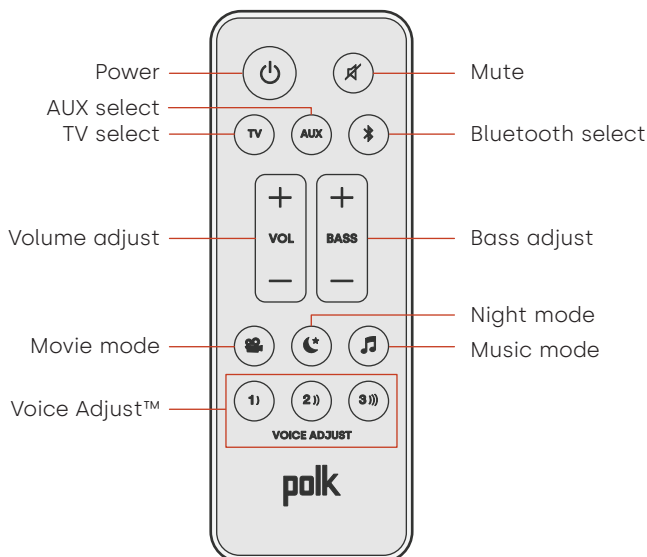

Sound Modes



Movie Mode

Enhances audio reproduction in TV and movies.



Night Mode

Reduces bass and volume dynamics while improving voice intelligibility for low-volume listening.



Music Mode

Enhances audio whenever you're listening to music, or watching TV or movies that have music playing in them.

VOICE ADJUST™

- 1) 2) 3)) Isolate and adjust the voice channel level to reproduce clear, crisp dialogue.



Dolby, Dolby Atmos, and the double-D symbol are registered trademarks of Dolby Laboratories Licensing Corporation. Manufactured under license from Dolby Laboratories. Confidential unpublished works. Copyright © 2012-2021 Dolby Laboratories. All rights reserved.



The terms HDMI, HDMI High-Definition Multimedia Interface, and the HDMI Logo are trademarks or registered trademarks of HDMI Licensing Administrator, Inc.



The Bluetooth® word mark and logos are registered trademarks owned by the Bluetooth SIG, Inc. and any use of such marks by Polk Audio is under license. Other trademarks and trade names are those of their respective owners.



5541 Fermi Court
Carlsbad, CA 92008, USA
www.polkaudio.com

Printed in China 5411 11934 00AK
© 2021 Sound United. All Rights Reserved.